

Diesel Spin-On - 120RMAM Series

FUEL

Specifications:

Height: 5.65" (14.35 cm)
Width: 3.2" (8.13 cm)
Depth: 3.31" (8.4 cm)
Weight (Dry): 1.4 lbs (0.64 kg)
Fuel Flow Rate: 15 gph (57 lph)
Ports: 1/4-18 NPTF
Service Clearance: 2.0" (5.1 cm)

Create a Part Number

Mounting Head	Bowl Material	Micron Rating
4 Port 15 gph (57 lph)	Marine - Metal Bowl	2 Micron
120R	MAM	30 Micron
		2 30

RACOR®

Dimensions:

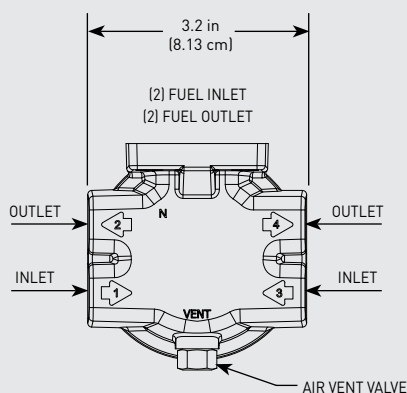

120RMAM Top

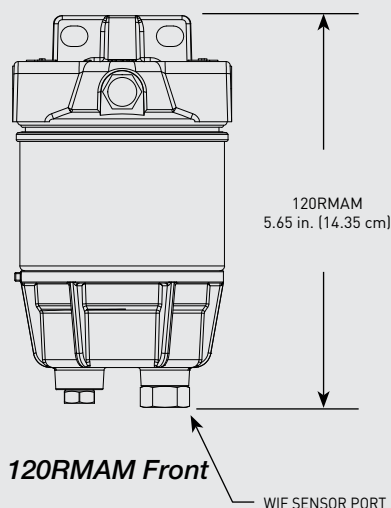

120RMAM Front

WIF SENSOR PORT

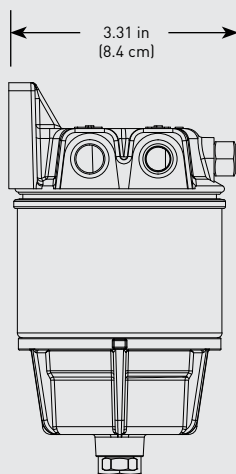

120RMAM Profile

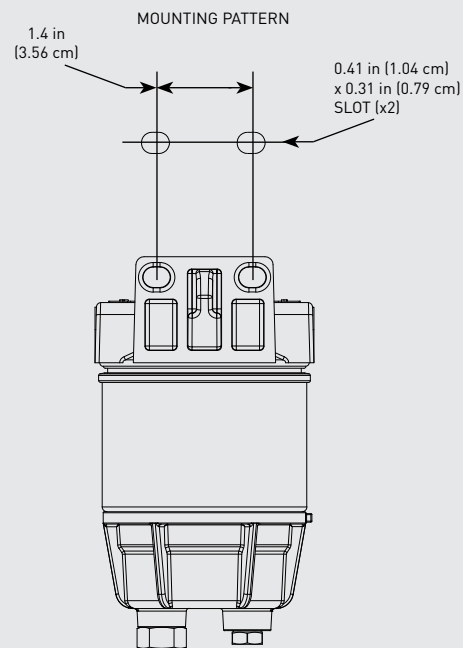

120RMAM Back

ASSEMBLIES	DESCRIPTION
120RMAM2	FF/WS, Marine Metal Bowl, 15 gph Flow Rate, 2 Micron Filtration
120RMAM30	FF/WS, Marine Metal Bowl, 15 gph Flow Rate, 30 Micron Filtration



PARTS

Diesel Spin-On - 120RMAM Series

1

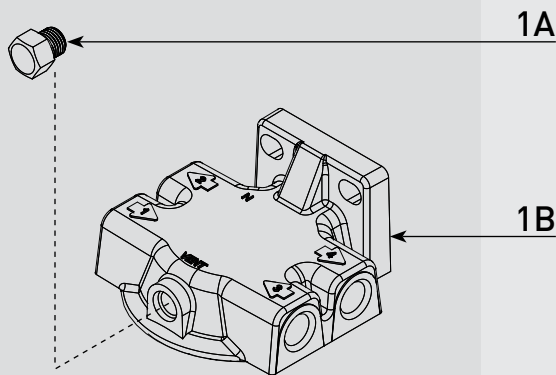

Part #	Description
1A RK 10110	Vent Plug Kit - 3/8-24 SAE Plug
1B	120 Series Head Assembly

2A	Square Cut Gasket - <i>Included in 2B</i>
2B R12SUL R12PUL	120RMAM2 Replacement Filter - 2 micron - <i>Includes 2A, 2C</i> 120RMAM30 Replacement Filter - 30 micron - <i>Includes 2A, 2C</i>
2C	Bowl O-ring - <i>Included in 2B & 3A</i>

3A RK 10226	Replacement Metal Bowl Kit - <i>Includes 2C, 3B, and 3C</i>
3B	Bowl Drain Port Plug Kit
3C	Bowl WIF Port Plug Kit

Additional Parts (not shown)

4A RK30880E RK23191	WIF Sensor/Detection Kit - 1/2"-20 UNF WIF Stainless Steel Probe Kit (1/2"-20 SAE - UL Listed/ABS Marine Type Approved) - No Internal Resistor, 12/24V - <i>Requires Water Detection Amplifier - See RSL7501 for available Probes, Sensors, and Amplifiers</i>
4B RK 11-1570	Water Detection Module Kit - 12 or 24 vdc - <i>Includes Amplifier (Light and Buzzer) & RK 21069 (WIF Probe)</i> <i>See RSL7501 for available Probes, Sensors, and Amplifiers</i>

2

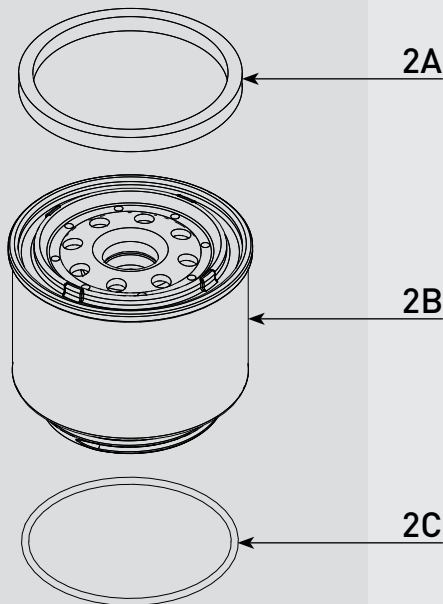

3

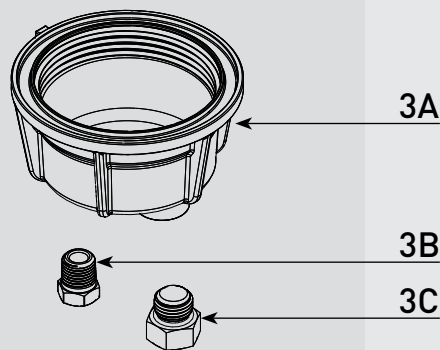

Online Link
Diesel Marine Spin-On Product Selector



RSL0378_CUT_SpinOn_120RMAM-Series (03/25 Rev A)

Questions? Email: racortech@parker.com Phone: 800-344-3286 News: www.racornnews.com