



# V758P

## Instruction and Installation Sheet

### PXM

#### WARNING

- To avoid unpredictable system behavior that can cause personal injury and property damage:
- Disconnect electrical supply (when necessary) before installation, servicing, or conversion.
- Disconnect air supply and depressurize all air lines connected to this product before installation, servicing, or conversion.
- Operate within the manufacturer's specified pressure, temperature, and other conditions listed in these instructions.
- Medium must be moisture-free if ambient temperature is below freezing.
- Service according to procedures listed in these instructions.
- Installation, service, and conversion of these products must be performed by knowledgeable personnel who understand how pneumatic products are to be applied.
- After installation, servicing, or conversion, air and electrical supplies (when necessary) should be connected and the product tested for proper function and leakage. If audible leakage is present, or the product does not operate properly, do not put into use.
- Warnings and specifications on the product should not be covered by paint, etc. If masking is not possible, contact your local representative for replacement labels.

#### Safety Guide

For more complete information on recommended application guidelines, see the Safety Guide section of Pneumatic Division catalogs or you can download the **Pneumatic Division Safety Guide** at: [www.parker.com/safety](http://www.parker.com/safety)

#### WARNING

**FAILURE OR IMPROPER SELECTION OR IMPROPER USE OF THE PRODUCTS AND/OR SYSTEMS DESCRIBED HEREIN OR RELATED ITEMS CAN CAUSE DEATH, PERSONAL INJURY AND PROPERTY DAMAGE.**

This document and other information from Parker Hannifin Corporation, its subsidiaries and authorized distributors provide product and/or system options for further investigation by users having technical expertise. It is important that you analyze all aspects of your application, including consequences of any failure and review the information concerning the product or systems in the current product catalog. Due to the variety of operating conditions and applications for these products or systems, the user, through its own analysis and testing, is solely responsible for making the final selection of the products and systems and assuring that all performance, safety and warning requirements of the application are met.

The products described herein, including without limitation, product features, specifications, designs, availability and pricing, are subject to change by Parker Hannifin Corporation and its subsidiaries at any time without notice.

**EXTRA COPIES OF THESE INSTRUCTIONS ARE AVAILABLE FOR INCLUSION IN EQUIPMENT / MAINTENANCE MANUALS THAT UTILIZE THESE PRODUCTS. CONTACT YOUR LOCAL REPRESENTATIVE.**

### Introduction

Follow these instructions when installing, operating, or servicing the product.

### Installation & Operating Instructions:

The Pilot Exhaust Module (PXM) is installed between an HA (ISO size 01) valve and a manifold segment. This valve in conjunction with PXM controls the presence of 14 pilot control pressure in a specific pressure zone in the manifold. This valve and PXM must be mounted in the pressure zone.

The pressure zone begins at a segment with the left gasket pilot ports 12 & 14 blocked. The pressure zone ends at either the right end plate of the manifold or at the next segment with the pilot ports 12 & 14 blocked. If a high flow end plate is the end of the pressure zone, the 12 & 14 ports must be plugged in the end plate.

Minimum operating pressure of the HA valve on the PXM must be present in the main pressure galley (port 1) of the manifold segment. Valves with pilots controlled in the

pressure zone must be externally piloted to the 14 pilot port, and 2 position single solenoid valves must have a spring return mechanism incorporated in the 12 end return operator. Any valve in this zone configured as internally piloted or using sandwich regulator will NOT have their pilot pressure controlled by the PXM.

These conditions will be seen at the externally piloted valves with solenoids energized and PXM has exhausted zoned pilot pressure:

- 5/2 Single Solenoid valves (with mechanical spring) will shift to the 12 position.
- 5/2 Double Solenoid valves will remain in the "last energized state".
- 5/3 Double Solenoid valves will shift to the "center position".

### Lubrication

Factory pre-lubed. If lubricating in service, use Parker F442 oil or equivalent paraffin based mineral oil with 150 to 200 SSU viscosity @100°F.

**CAUTION: Do not use oils that are synthetic, reconstituted, have an alcohol content or a detergent additive.**

### Application Limits

These products are intended for use in general purpose compressed air systems only.

**Operating Pressure Range:** Maximum 145 PSIG (1000 kPa)

**Ambient Temperature Range:** -15°C to 49°C (5°F to 120°F)

### Installation:

#### Warning:

Not following instruction may result in Pilot Exhaust Manifold damage or inadequate thread engagement, which may lead to personal injury, property damage, or economic loss

#### Important:

- Remove pressure and electrical connections before installation.
- All threads on tie rods and screws must be free of rust, water or other debris, which could prevent finger thread engagement

### Install Pressure Switch

1. Remove Plug (3) and Plug Gasket (2) from body. Separate the Plug Gasket (2) from Plug (3).

Item	Description
1	ISO Pilot Exhaust Module (PXM) Base
2	Plug Gasket
3	Plug
4	Pressure Switch

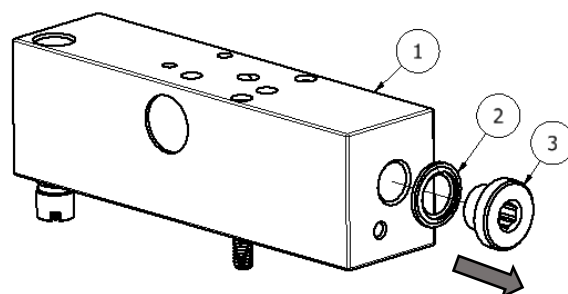

2. Install Plug Gasket (2) to Pressure Switch (4).

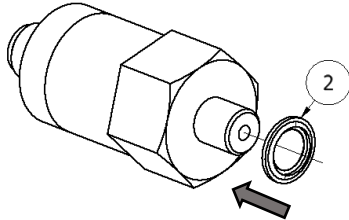

3. Install Pressure Switch (4).

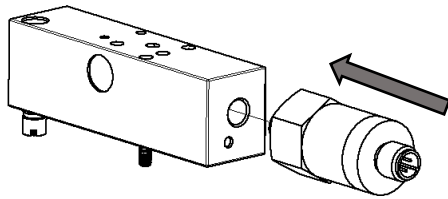

4. Using hex wrench, tighten Pressure Switch (4) – torque 1.5 to 1.7 Nm (13 to 15 in-lb)

#### Step 1: Install Tie Rods

1. Install two Tie Rods (5) to the base, torque finger tight.
2. Adjust tie rod height to 28.5/28.0 mm (1.12/1.10 inch) as figure shows.
3. If finger tight height exceeds 28.5 mm (1.12 inch), use mechanical tightening as necessary to get the proper height.

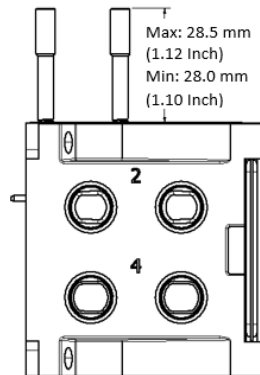

#### Step 2: Install Pilot Exhaust Module

1. Lay the PXM gasket (6) on the base. Make sure the two rubber projections are face up and the orientation of the gasket is correct.
2. Engage both tie rods (5) into mounting holes on PXM body, lower the PXM body.
3. Carefully engage the electrical plug into the base.
4. Continue to lower the PXM body by carefully engaging the two rubber projections on the gasket into the appropriate holes on the PXM body.
5. Press the PXM body by hand firmly. To confirm the gasket is indeed attached to the PXM body, lift the PXM body by about one half inch. Both rubber projections should remain in the holes.
6. Lay the PXM body back on the base.

#### Step 3: Install Valve

1. Locate valve gasket (7) on bottom of valve body (8).
2. Install valve onto PXM.
3. Carefully engage the valve electrical plug.
4. Using hex wrench, tighten two Screws (9) – torque 1.5 to 1.7 Nm (13 to 15 in-lb)

#### Step 4: Leakage Check

1. Apply pressure to base and check for audible leakage at various joints. If any are present, do not operate the valve, repeat the assembly procedure until satisfied.

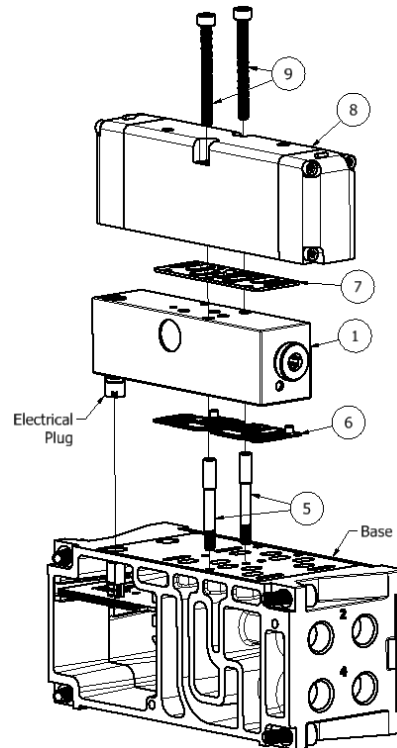

Figure 1: ISO Pilot Exhaust Module (Valve and Base shown for reference only)

#### Component List

The components listed below are for identification purposes only. Individual components are not sold separately.

Item	Description
1	ISO Pilot Exhaust Module (PXM) Base
5	Tie Rods
6	Pilot Exhaust Module (PXM) Gasket
7	HA Valve Gasket
8	HA Valve
9	Mounting Screws

Installation & Service Instructions  
V758P  
PXM, General Installation  
ISSUED: November 2019  
Supersedes: None  
Doc. #V758P, EN# 190862, Rev -