

Chelsea® 823 Series

Heavy Duty 8-Bolt PTO for Mechanical Transmissions



Overview:

The Chelsea 823 PTO is the most robust PTO in the world. This workhorse features a cast iron housing, tapered cone bearings on the output shaft, and the widest possible gears giving it the highest torque rating and longest service life possible. The space saving air shift design provides maximum clearance under the truck. The 823 Series comes standard with a 1410 Series companion flange. Six internal speed ratios and four shift options make this one versatile PTO. Take advantage of over 70 years of Chelsea PTO technology to increase performance and lower costs.

- Oil Fields
- Logging
- Pumper Cleaner
- Mining
- Heavy Duty Blower

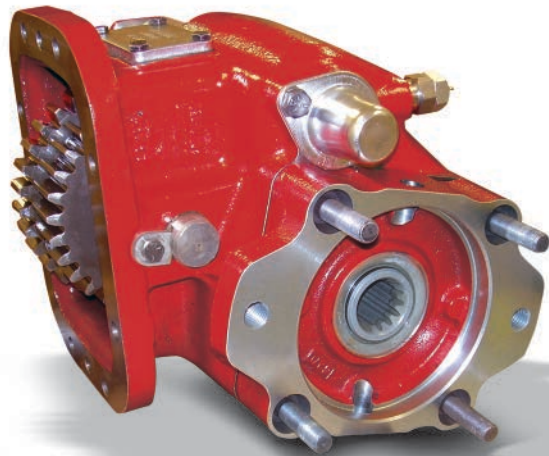

Contact Information:

Parker Hannifin Corporation
Chelsea Products Division
8225 Hacks Cross Road
Olive Branch, MS 38654 USA

Phone: 1-888-PH4-TRUK
(1-888-744-8785)

Fax: 1-662-895-1069
chelseacustserv@parker.com

www.parker.com/chelsea

Product Features and Benefits:

- **Power** – Intermittent Torque Rating up to 750 lbs-ft
- **Ease of Installation** – Inspection cover for adjusting backlash
- **Output Options** – Four popular pump mount options
- **Durability** – Wet Spline available
- **Shift Options** – Four available
- **Confidence** – Two Year Warranty



ENGINEERING YOUR SUCCESS.

823 SERIES POWER TAKE-OFF SPECIFICATIONS AND TECHNICAL DATA

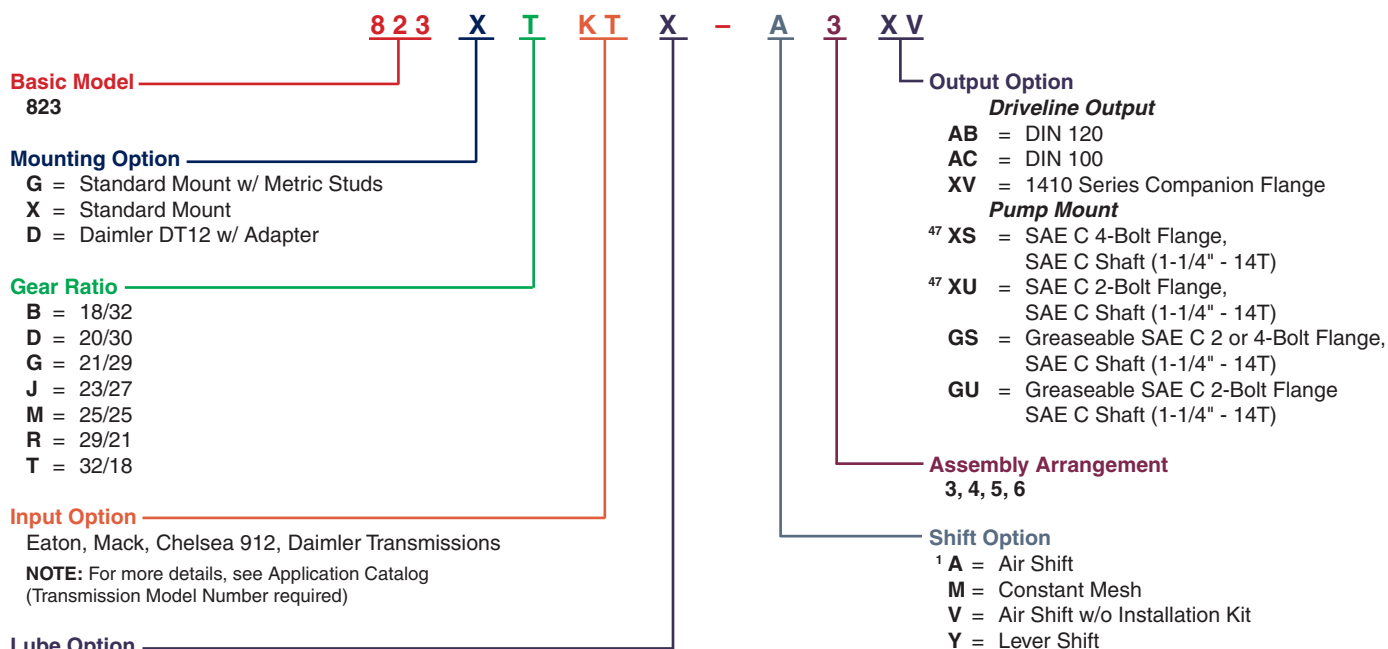

¹ Includes mounting parts.

⁴⁷ Available with Wet Spline

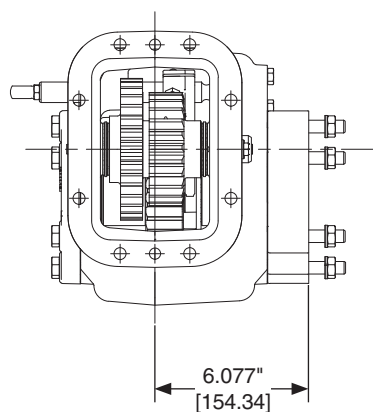

Assembly 3

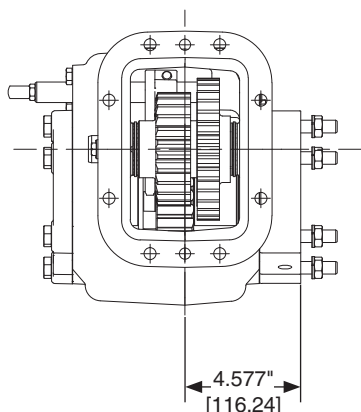

Assembly 4

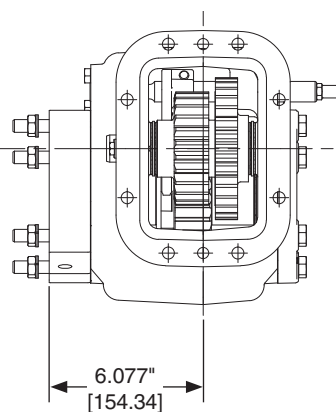

Assembly 5

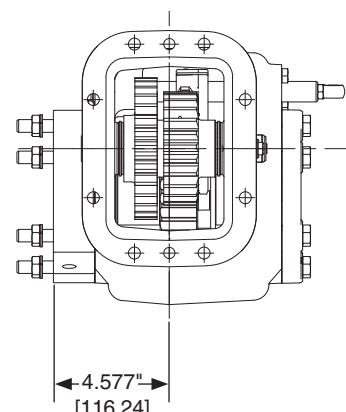

Assembly 6

Specifications Chart

Approximate Weight: 76 lbs. [34.5 kg]

	823*B	823*D	823*G	823*J	823*M	823*R	823*T
Intermittent Torque Rating (lbs-ft) [Nm]	750 [1017]	750 [1017]	750 [1017]	750 [1017]	750 [1017]	550 [746]	500 [678]
HP Rating for Intermittent Service							
At 500 RPM of Output Shaft (HP) [Kw]	71 [53]	71 [53]	71 [53]	71 [53]	71 [53]	52 [39]	47 [35]
At 1000 RPM of Output Shaft (HP) [Kw]	143 [107]	143 [107]	143 [107]	143 [107]	143 [107]	104 [78]	95 [71]

© 2020 Parker Hannifin Corporation

Supersedes HY25-0099-B1/US April 2020 HY25-0099-B1/US November 2020



ENGINEERING YOUR SUCCESS.