

AS PAINTED  
COLOR SHOWN FOR REFERENCE ONLY  
SCALE 1 : 2

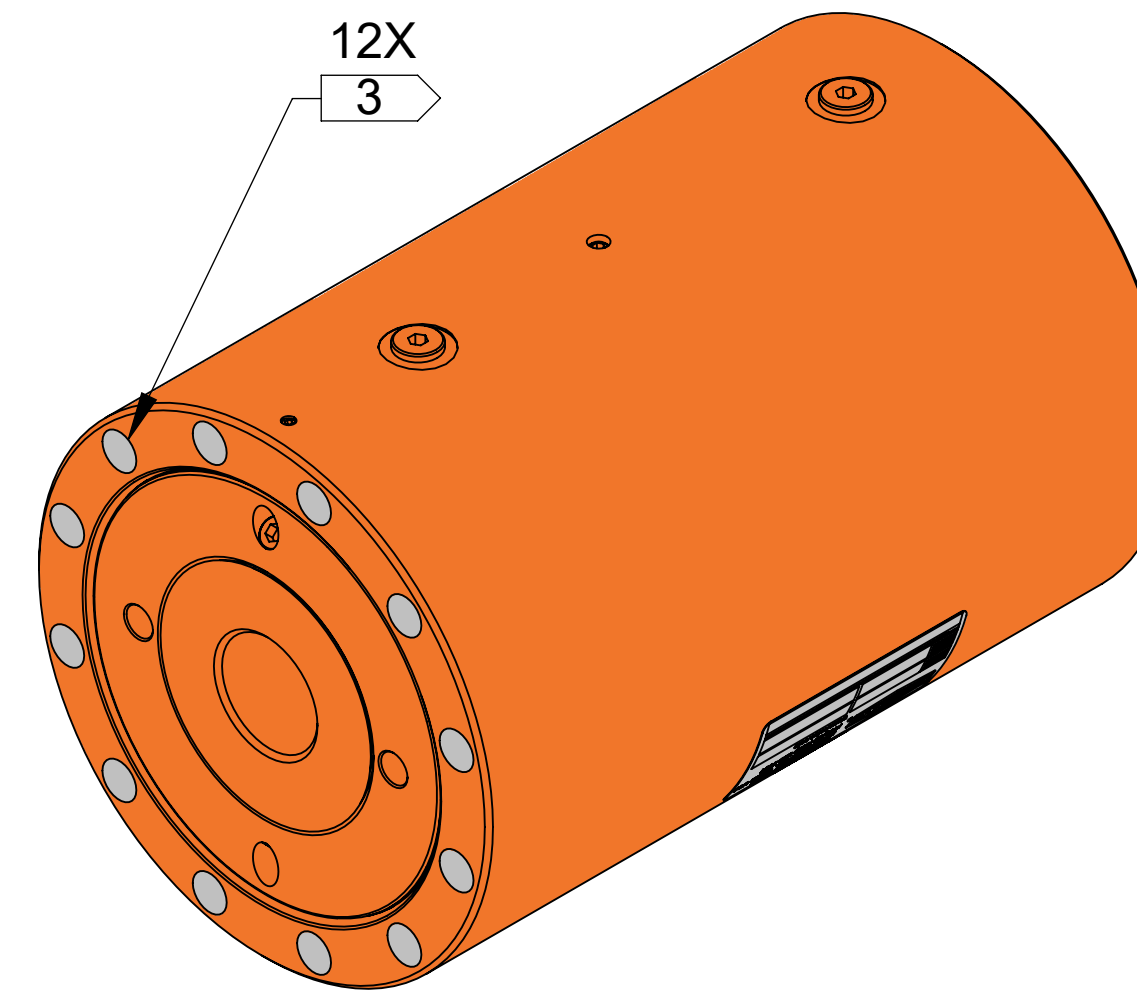

AS PAINTED  
COLOR SHOWN FOR REFERENCE ONLY  
SCALE 1 : 2

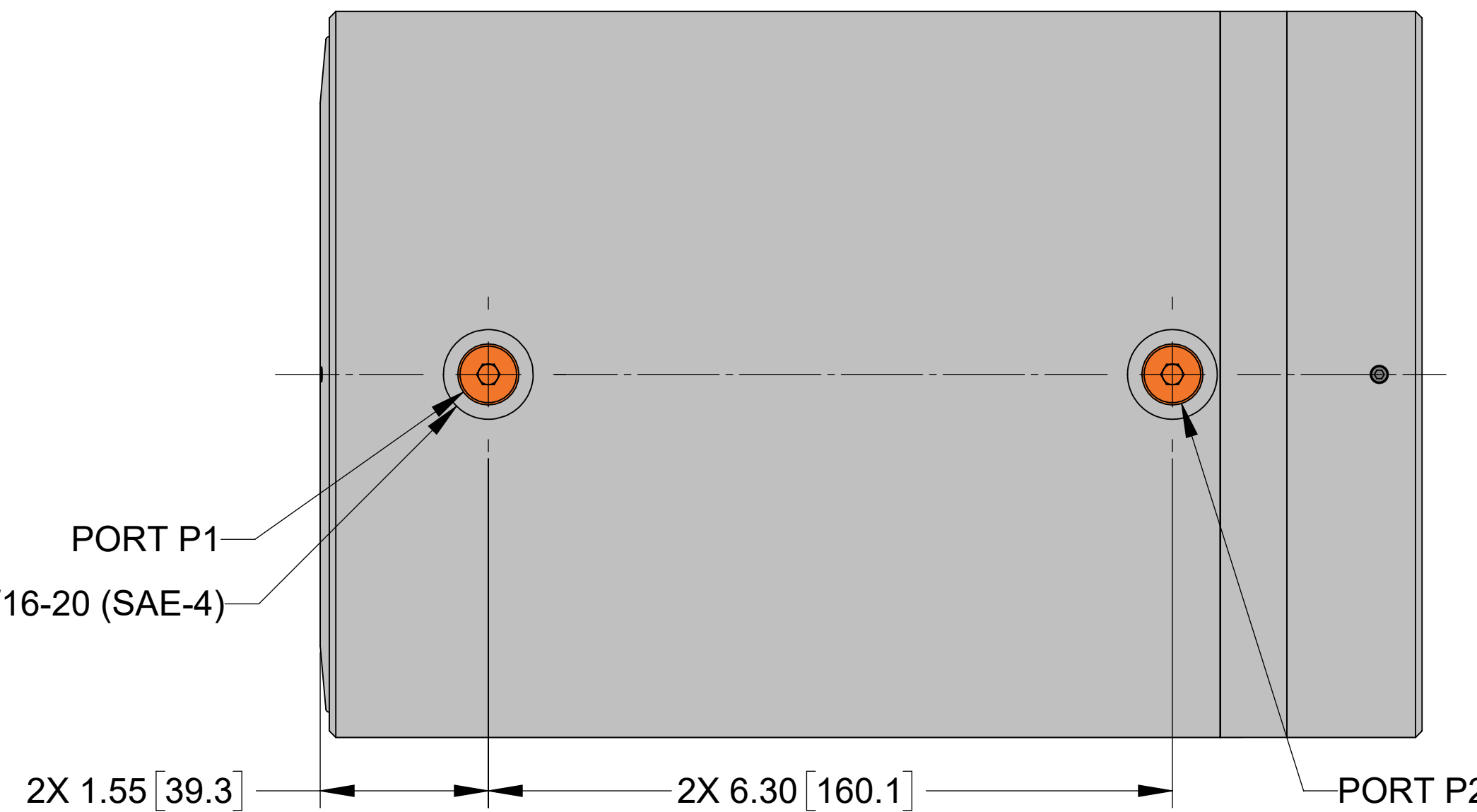
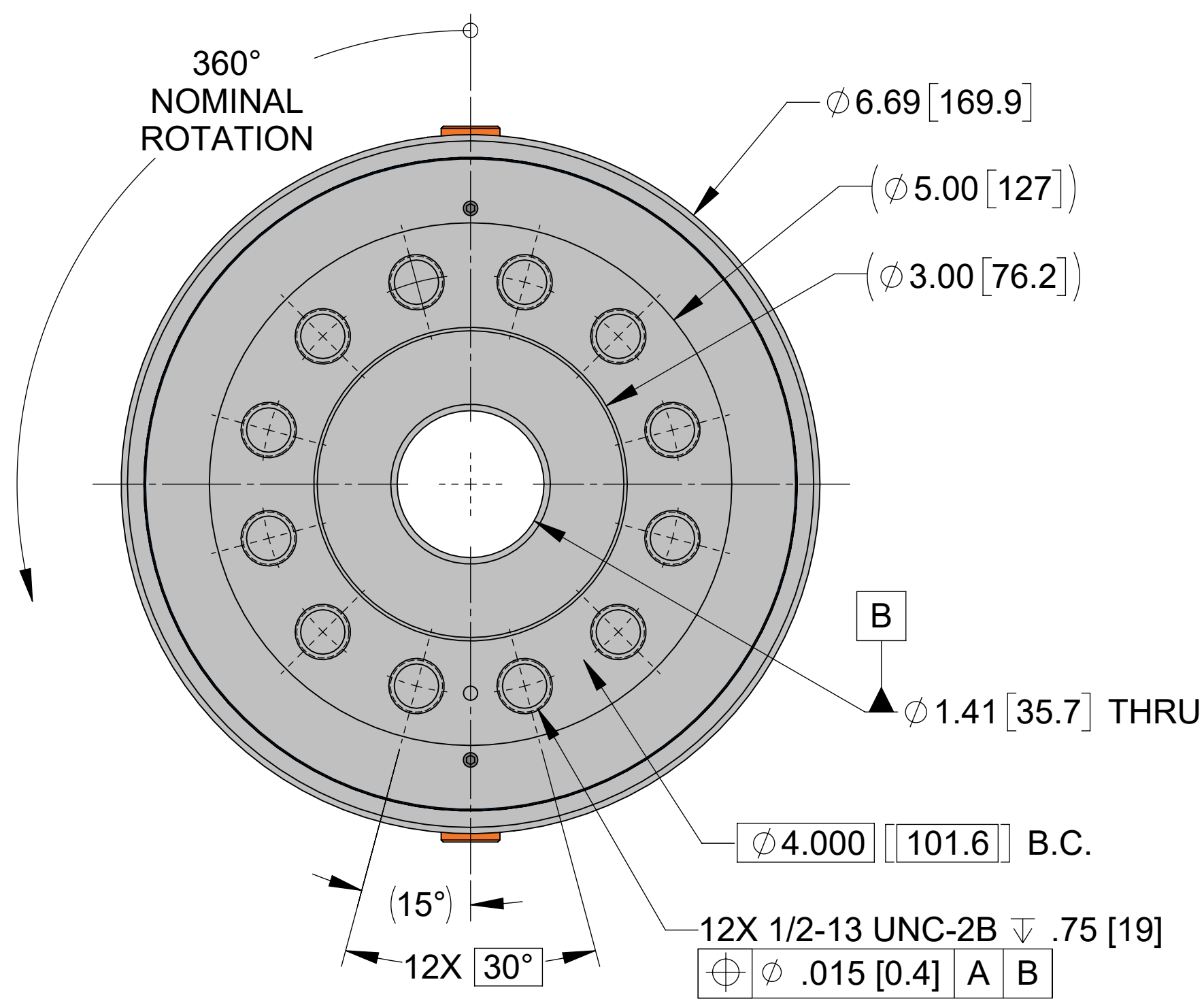

SHAFT FLANGE  
PRIMARY OUTPUT

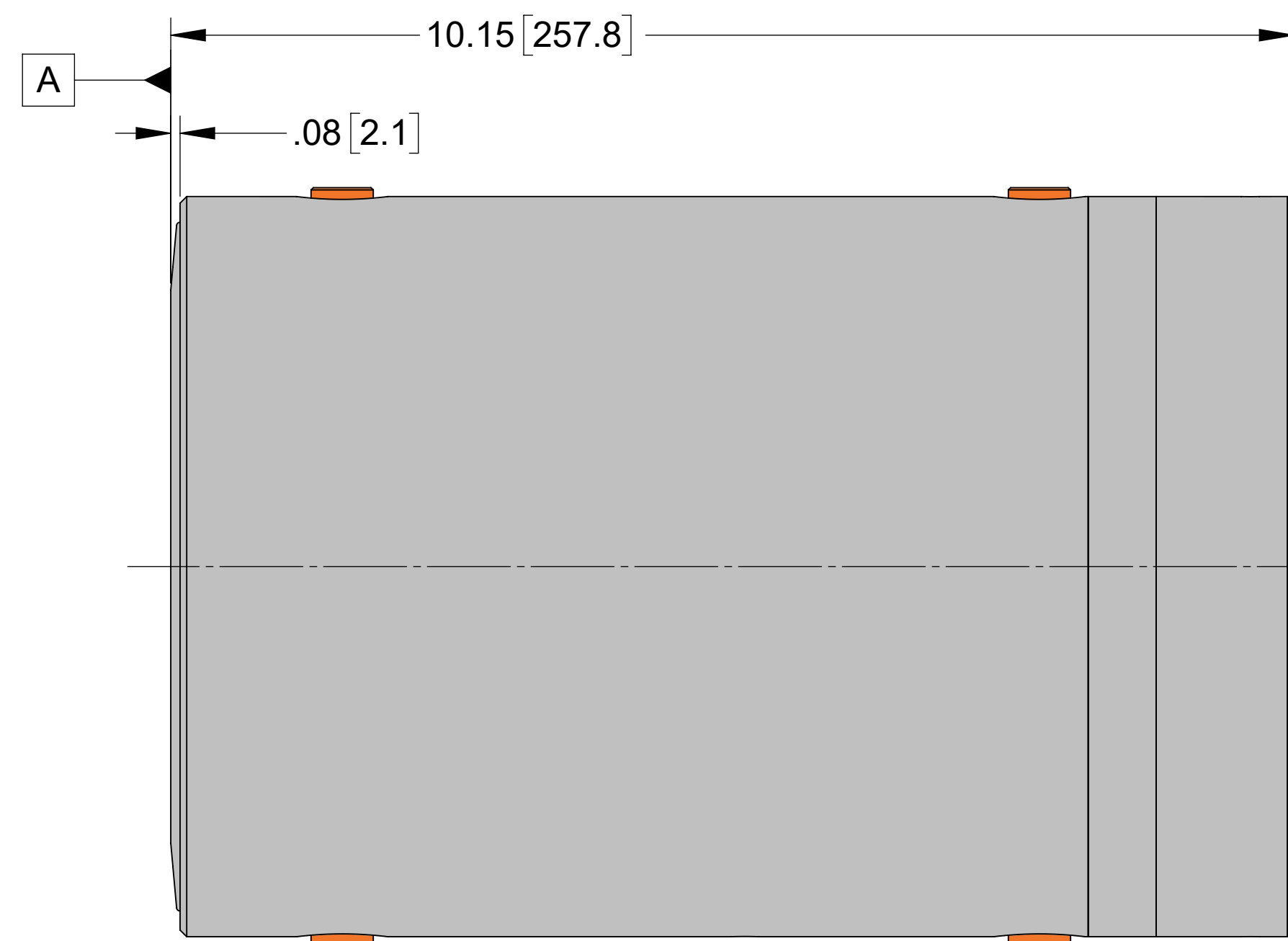

$\phi$  5.94 [150.8] B.C.  
12X 1/2-13 UNC-2B  $\nabla$  .75 [19]  
 $\oplus$   $\phi$  .015 [0.4] C B

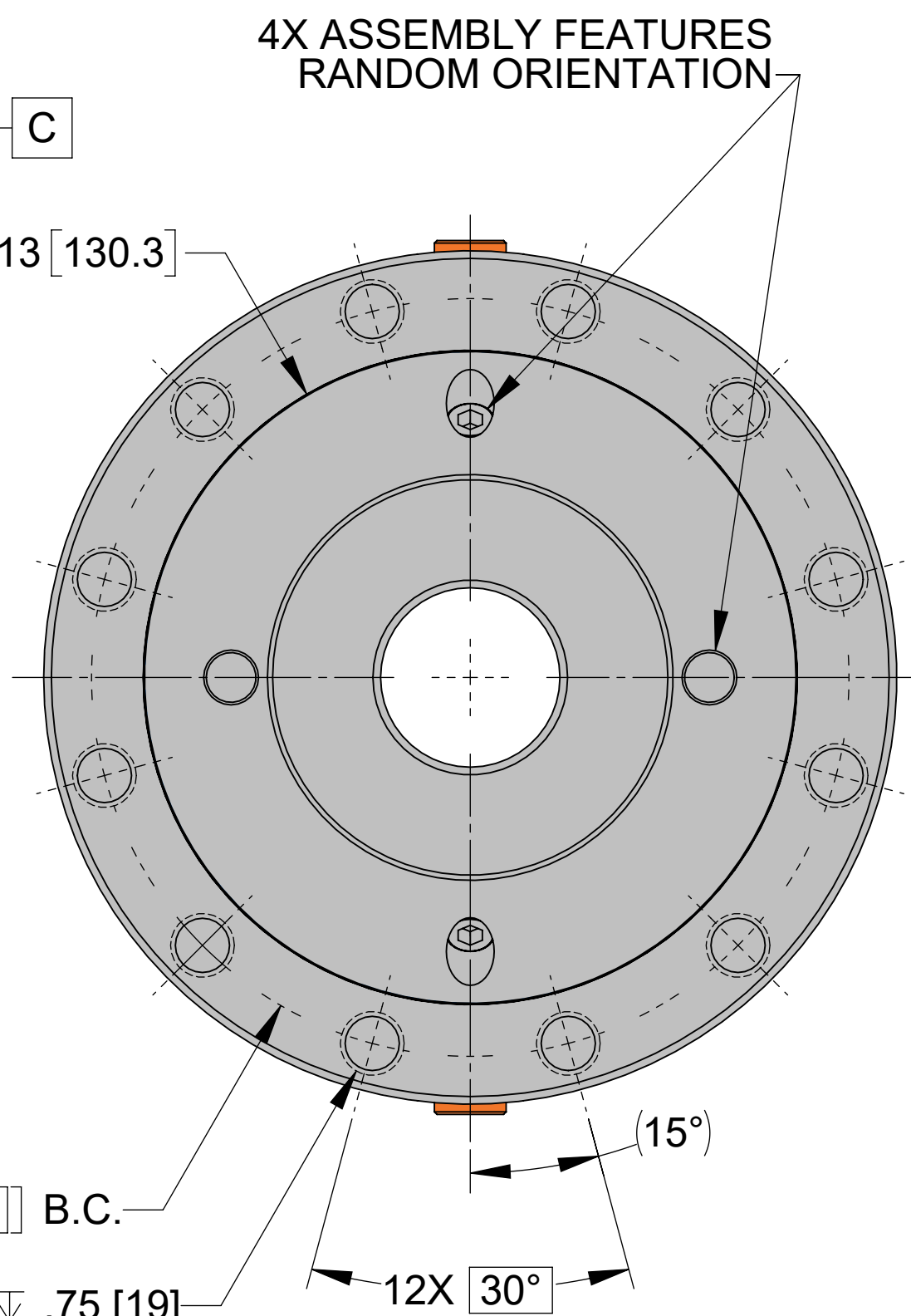

HOUSING FLANGE  
SECONDARY OUTPUT

NOTES: UNLESS OTHERWISE SPECIFIED

1. THE ACTUATOR IS SHIPPED IN POSITION SHOWN  $\pm 1^\circ$  (SHAFT FLANGE). AS PRESSURE IS APPLIED TO PORT P1, THE SHAFT WILL ROTATE COUNTERCLOCKWISE.
2. MAXIMUM BACKLASH IN GEAR SET IS  $1^\circ$ . SEAL MOVEMENT, SEAL COMPRESSION, END PLAY, AND FLUID COMPRESSION MAY RESULT IN ADDITIONAL ROTATION.

3 NO PAINT ON INDICATED FEATURE.

| REV | DESCRIPTION                          | REVISIONS | DATE       | RESP |
|-----|--------------------------------------|-----------|------------|------|
| ①   | INITIAL RELEASE                      |           | 2003/01/07 | SWD  |
| ②   | UPDATE GREASE FITTING                |           | 2003/12/12 | SWD  |
| ③   | CATALOG UPDATE TO CURRENT STANDARDS. |           | 2021/03/05 | MCC  |

### CANTILEVER MOUNT

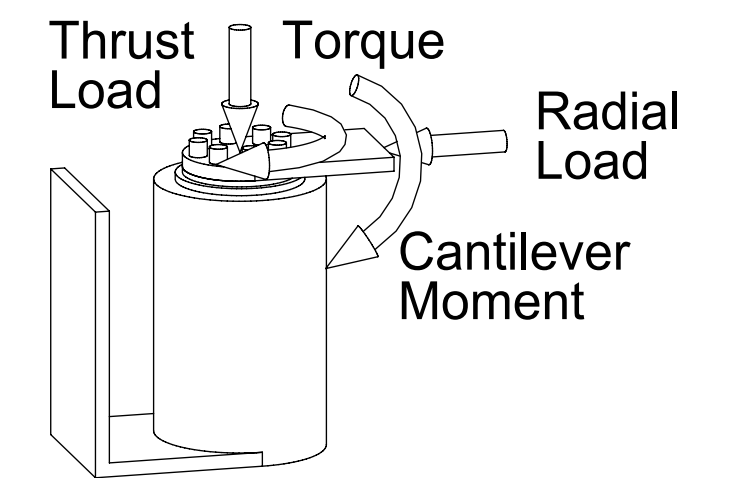

### WARNING

THIS DOCUMENT AND THE INFORMATION IT CONTAINS IS CONFIDENTIAL AND PROPRIETARY TO PARKER SYSTEMS CORPORATION AND ITS AFFILIATES ("PARKER"), MAY NOT BE COPIED OR DISCLOSED TO OTHERS OR USED FOR ANY PURPOSE OTHER THAN CONDUCTING BUSINESS WITH PARKER, AND MUST BE RETURNED OR DESTROYED AND ALL FURTHER USE DISCONTINUED AT PARKER'S REQUEST.

THE RECIPIENT OF THIS DOCUMENT IS ADVISED THAT IMPROPER SELECTION OR IMPROPER USE OF PARKER SYSTEMS OR COMPONENTS CAN CAUSE DEATH, PERSONAL INJURY AND PROPERTY DAMAGE, AND IS SOLELY RESPONSIBLE THROUGH ITS OWN ANALYSIS AND TESTING FOR THE FINAL SELECTION OF PARKER SYSTEM AND COMPONENTS AND ASSURING THAT ALL PERFORMANCE, ENDURANCE, MAINTENANCE, SAFETY AND WARNING REQUIREMENTS OF THE INTENDED APPLICATION ARE MET.

COPYRIGHT PARKER. YEAR OF COPYRIGHT IS THE YEAR(S) INDICATED ON THIS DOCUMENT. ALL RIGHTS RESERVED.

### PERFORMANCE SPECIFICATIONS

|  |                         |                          |
|--|-------------------------|--------------------------|
| DRIVING TORQUE, AT OPERATING PRESSURE, RATED | 9,500 in-lb             | 1074 Nm                  |
| HOLDING TORQUE, AT OPERATING PRESSURE, RATED | 34,000 in-lb            | 3842 Nm                  |
| MAXIMUM PRIMARY OUTPUT TORQUE                | 100% OF TOTAL           |                          |
| MAXIMUM SECONDARY OUTPUT TORQUE              | 10% OF TOTAL            |                          |
| OPERATING PRESSURE, RATED                    | 3,000 psi               | 207 bar                  |
| NOMINAL ROTATION                             | 360°                    |                          |
| DISPLACEMENT                                 | (44.7 in <sup>3</sup> ) | (732.5 cm <sup>3</sup> ) |
| OPERATING OIL TEMPERATURE                    | 0/+160°F                | -18/+71°C                |
| DRY WEIGHT                                   | (77 lb)                 | (35 kg)                  |
| STRADDLE MOMENT, RATED                       | N/A                     | N/A                      |
| CANTILEVER MOMENT, RATED                     | 50,000 in-lb            | 5650 Nm                  |
| RADIAL LOAD, RATED                           | 8,000 lb                | 3629 kg                  |
| AXIAL LOAD, RATED                            | 8,000 lb                | 3629 kg                  |

UNLESS OTHERWISE SPECIFIED, DIMENSIONS ARE IN INCHES. METRIC DIMENSIONS ARE FOR REFERENCE ONLY. FORMAT: INCHES [mm]

XXX =  $\pm$ 0.010 [0.254]  
XX =  $\pm$ 0.030 [0.762]  
X =  $\pm$ 0.060 [1.524]

(X.XXX [X.XXX]) = REFERENCE  $\checkmark$  =  $\mu$ in

DIMENSIONING AND TOLERANCING PER ASME Y14.5-2009



DO NOT SCALE DRAWING

### CUSTOMER REVIEWED

SIGNATURE

DATE



PHONE (360) 825-1601 FAX (360) 825-1603  
www.helac.com

| APPROVALS           | DATE       |
|---------------------|------------|
| DRAWN<br>S. DEHLINE | 2003/01/06 |
| RESP ENG<br>S. NEEL | 2003/01/06 |

|                     |                   |
|---------------------|-------------------|
| SIMILAR TO<br>53688 | ET #<br>5105,8377 |
| SCALE:<br>1:1       | SHEET:<br>1 of 1  |

ACTUATOR  
CUSTOMER INTERFACE DRAWING  
L10-9.5-E-RF-360-S1-O-H

SIZE D  
DRAWING NUMBER  
**53685**

REV.  
B