

Specifications:

- Steel body
- Side Inlet Port: 7.0" Diameter
- Outlet Ports: 7.0" Diameter
- Flow rates: 980 - 1670 cfm
- Assembly Lengths: 15.0" - 24.0"
- Assembly Diameters: 11.0" and 13.5"
- For Scheduled Maintenance

Engine Displacement Formula:

$$CFM = HP \times SA$$

SA = Specific Airflow rating

- 4-Stroke naturally aspirated diesel engine: **SA = 2.0**
- 4-Stroke turbo charged diesel engine: **SA = 2.3**
- 4-Stroke turbo charged after cooled diesel engine: **SA = 2.3**
- 2-Stroke naturally aspirated diesel engine: **SA = 2.0**
- 2-Stroke scavenge blower diesel engine: **SA = 3.3**
- 2-Stroke turbo charged diesel engine: **SA = 3.6**

Dimensions:

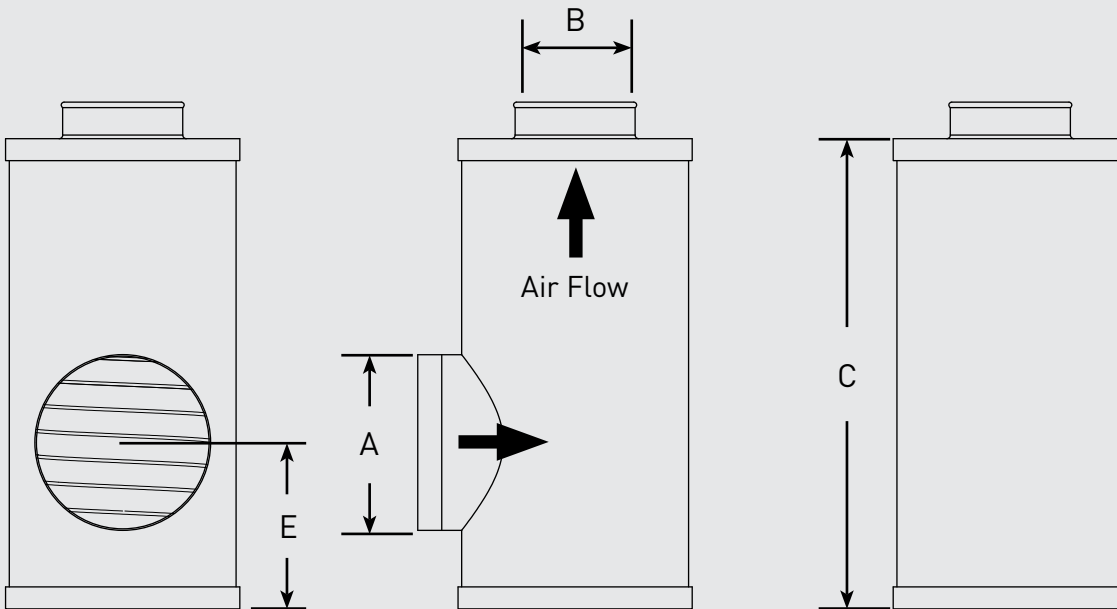
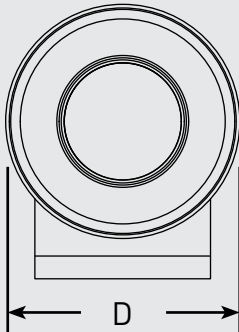

Side Inlet

SIDE INLET ASSEMBLY	(A) INLET OD IN (CM)	(B) OUTLET ID IN (CM)	(C) LENGTH IN (CM)	(D) DIAMETER IN (CM)	(E) DISTANCE IN (CM)	FLOW RATE CFM	WEIGHT LBS (KG)
099842002	7.0 (17.8)	7.0 (17.8)	24.0 (61.0)	11.0 (27.9)	12.0 (30.5)	980-1430	19.0 (8.6)
099842004	7.0 (17.8)	7.0 (17.8)	24.0 (61.0)	13.5 (34.3)	5.5 (14.0)	1100-1670	27.0 (12.2)
099842005	7.0 (17.8)	7.0 (17.8)	24.0 (61.0)	13.5 (34.3)	12.0 (30.5)	1130-1500	27.0 (12.2)
099842006	7.0 (17.8)	7.0 (17.8)	24.0 (61.0)	13.5 (34.3)	18.5 (47.0)	1030-1500	27.0 (12.2)
099842007	7.0 (17.8)	7.0 (17.8)	18.0 (45.7)	13.5 (34.3)	5.5 (14.0)	1120-1630	24.0 (10.9)
099842009	7.0 (17.8)	7.0 (17.8)	15.0 (38.1)	13.5 (34.3)	5.5 (14.0)	1070-1550	22.5 (10.2)
099842010	7.0 (17.8)	7.0 (17.8)	15.0 (38.1)	13.5 (34.3)	9.5 (24.1)	1060-1530	22.5 (10.2)



WARNING: The products described in this literature can expose you to chemicals including Diisononyl phthalate, Carbon black extract, which are known to the State of California to cause cancer. For more information go to www.P65Warnings.ca.gov.



PARTS

ECO-SM Series

1

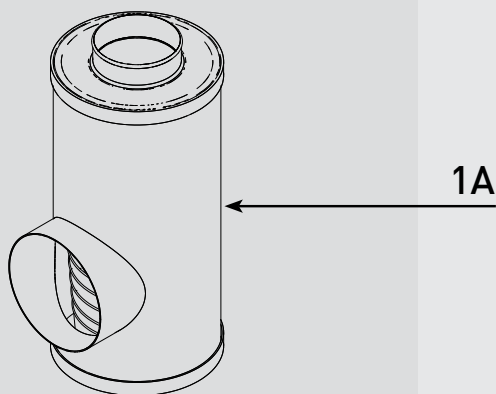

1A

Part #	Description
1A 099842002	Side Inlet - (D) 11.0 in., (L) 24.0 in., (OD) 7.0 in., (ID) 7.0 in., (Inlet Port Location from Base) 12.0 in.
099842004	Side Inlet - (D) 13.5 in., (L) 24.0 in., (OD) 7.0 in., (ID) 7.0 in., (Inlet Port Location from Base) 5.5 in.
099842005	Side Inlet - (D) 13.5 in., (L) 24.0 in., (OD) 7.0 in., (ID) 7.0 in., (Inlet Port Location from Base) 12.0 in.
099842006	Side Inlet - (D) 13.5 in., (L) 24.0 in., (OD) 7.0 in., (ID) 7.0 in., (Inlet Port Location from Base) 18.5 in.
099842007	Side Inlet - (D) 13.5 in., (L) 18.0 in., (OD) 7.0 in., (ID) 7.0 in., (Inlet Port Location from Base) 5.5 in.
099842009	Side Inlet - (D) 13.5 in., (L) 15.0 in., (OD) 7.0 in., (ID) 7.0 in., (Inlet Port Location from Base) 5.5 in.
099842010	Side Inlet - (D) 13.5 in., (L) 15.0 in., (OD) 7.0 in., (ID) 7.0 in., (Inlet Port Location from Base) 9.5 in.

2A 071921002	Mounting Clamp - (D) 11.0 in.
071921003	Mounting Clamp - (D) 13.5 in.

2

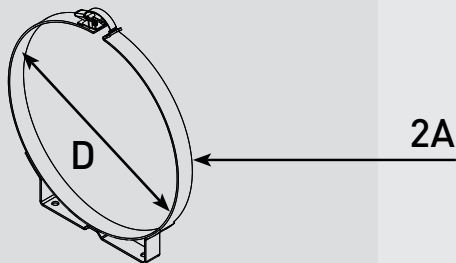

2A

Online Link
Disposasable Engine Air Filters Product Selector



RSL0390_CUT_ECO-SM (07/18 Rev -)

Questions? Email: racortech@parker.com Phone: 800-344-3286 News: www.racornews.com