

Chelsea® 447 Series

Two Gear PTO for Mechanical Transmissions



Overview:

Chelsea's 447 Series is another problem solving PTO. It features a one-piece input gear that has a space between the two sets of gear teeth. This helps eliminate interference problems within the PTO aperture on transmissions that might have adjacent gear interference. The 447 Series features the same options as the popular 442 Series plus a few more with special options to simplify the installation of PTOs on Mitsubishi FUSO and Nissan trucks. The 447 Series is available with the adapter or unique installation kit that may be required for these vehicles. The 447 has strong tapered bearings instead of needle bearings for greater load bearing capability. Twenty-four output options including Chelsea's popular 360° rotatable flange, four internal speed ratios and eleven shift options plus a self-lube option for transmissions that have problems getting lubrication to the PTO make this one versatile PTO. Take advantage of over 70 years of Chelsea PTO technology to increase performance and lower costs.

- Aerial
- Fire & Rescue
- Snow & Ice Removal
- Refuse
- Dump Trucks & Trailers
- Service



Contact Information:

Parker Hannifin Corporation
Chelsea Products Division
8225 Hacks Cross Road
Olive Branch, MS 38654 USA

Phone: 1-888-PH4-TRUK
(1-888-744-8785)

Fax: 1-662-895-1069
chelseacustserv@parker.com

www.parker.com/chelsea

Product Features and Benefits:

- **Innovative** – Eliminates interference problems inside transmission/PTO opening.
- **Output Options** – Pump and Driveshaft options.
- **Confidence** – Two Year Warranty.
- **Ease of Installation** – Reduced installation time.
- **Input Gear** – One piece.
- **Shift Options** – Eleven shift options.
- **Speeds** – Four speed ratios.



ENGINEERING YOUR SUCCESS.

447 SERIES POWER TAKE-OFF SPECIFICATIONS AND TECHNICAL DATA

4 4 7 X S E S X - A 3 X D

Basic Model
447

Mounting Option
G = Standard Mount w/ Metric Stud Kit
K = Standard Mount w/o Stud Kit
L = Deep Mount w/o Stud Kit
X = Standard Mount
Z = Deep Mount

Gear Ratio
Q = 19/24
S = 24/22
U = 26/20
W = 26/17

Input Option
 Eaton, Mack, Tremac, Allison, Chelsea, Mercedes, Rockwell Transmissions
NOTE: For more details, see Application Catalog (Transmission Model Number required)

Lube Option
X = No Pressure Lube
Pressure
P = Pressure Lube

Shift Option
¹**A** = Air Shift
C = Special Shift Control & Bracket Kit
H = No Shift Kit
M = Constant Mesh
¹**P** = 12V Elec/Air Shift
V = Air Shift w/o Installation Kit
²¹**S** = Air Shift w/ PTO/Dump Pump Combo Valve w/ Kick Out w/ Neutral Spring Return
²¹**T** = Air Shift w/ PTO/Dump Pump Combo Valve w/o Kick Out w/ Neutral Spring Return
²¹**U** = Air Shift w/ PTO/Dump Pump Combo Valve w/ Kick Out w/o Neutral Spring Return
¹**W** = Wire Shift
X = Wire Shift w/o Cable & Knob

Output Option
Driveline Output
XD = Rd Standard Shaft (1-1/4" - 5/16" Key)
XX = 1-1/4" Tapered Output Shaft w/ Keyway
Pump Mount
XE = SAE A 2 or 4-Bolt Flange, SAE A Shaft (5/8" - 9T)
AK = SAE B 2-Bolt Flange, SAE B Shaft (7/8" - 13T)
XK = SAE B 2 or 4-Bolt Flange, SAE B Shaft (7/8" - 13T)
⁵⁹**XQ** = SAE B 2 or 4-Bolt Flange, SAE B Shaft (7/8" - 13T)
AF = SAE B 2 or 4-Bolt Flange, SAE BB Shaft (1" - 15T)
AZ = SAE B 2 or 4-Bolt Flange, SAE C Shaft (1-1/4" - 14T)
GA = Greaseable SAE B 2-Bolt Rotatable Flange, SAE B Shaft (7/8" - 13T)
GB = Greaseable SAE B 4-Bolt Rotatable Flange, SAE B Shaft (7/8" - 13T)
GK = Greaseable SAE B 2 or 4-Bolt Flange, SAE B Shaft (7/8" - 13T)
⁵⁹**GQ** = Greaseable SAE B 2 or 4-Bolt Flange, SAE B Shaft (7/8" - 13T)
GF = Greaseable SAE B 2 or 4-Bolt Flange, SAE BB Shaft (1" - 15T)
GR = Greaseable Chelsea Special (Cloverleaf), SAE B Shaft (7/8" - 13T)
RC = Rotatable SAE A 2-Bolt Flange, SAE A Shaft (5/8" - 9T)
RD = Rotatable SAE A 2-Bolt Flange, SAE B Shaft (7/8" - 13T)
RA = Rotatable SAE B 2-Bolt Flange, SAE B Shaft (7/8" - 13T)
RB = Rotatable SAE B 4-Bolt Flange, SAE B Shaft (7/8" - 13T)
RF = Rotatable SAE B 2-Bolt Flange, SAE BB Shaft (1" - 15T)
RK = Rotatable SAE B 2 or 4-Bolt Flange, SAE B Shaft (7/8" - 13T)
RE = Rotatable SAE B 4-Bolt Flange, SAE BB Shaft (1" - 15T)
RY = Rotatable ISO 7653 Pump Mount DIN 5462 Shaft
XR = Chelsea Special (Cloverleaf), SAE B Shaft (7/8" - 13T)
XY = ISO 7653 Pump Mount DIN 5462 Shaft

Assembly Arrangement
 3, 4, 5, 6

¹ Includes mounting parts
²¹ Includes installation kit, console sold separately
⁵⁹ Same as XK except rotated 90°

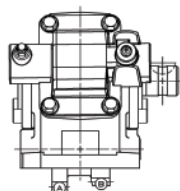

Ass'y 3

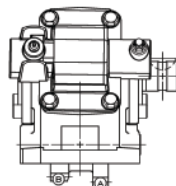

Ass'y 4

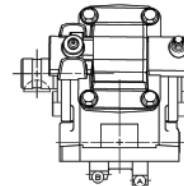

Ass'y 5

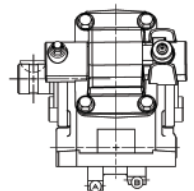

Ass'y 6

Specifications Chart	Approximate Weight: 21 lbs. [9.5 kg]			
	447*Q	447*S	447*U	447*W
Intermittent Torque Rating (lbs-ft) [Nm]	225 [305]	200 [271]	195 [264]	175 [237]
HP Rating for Duty				
At 500 RPM of Output Shaft (HP) [Kw]	21 [16]	19 [14]	19 [14]	17 [12]
At 1000 RPM of Output Shaft (HP) [Kw]	43 [32]	38 [28]	37 [28]	33 [25]