

XEMK46

90° BSP Swivel Adapter
37° Flare / BSPP 60° Cone Swivel

Swivel end mates with BS5200
(Parker K4) adapters and Parker
D9 hose fittings.

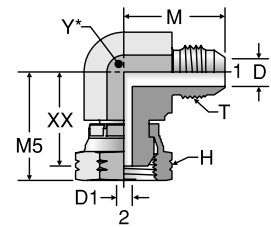

* Y – Across wrench flats

TUBE FITTING PART #	END SIZE		T TUBE END UN/UNF-2A	D DRILL (mm)	D1 DRILL (mm)	M (mm)	M5 (mm)	H HEX (mm)	XX (mm)	Y (mm)	Dynamic Pressure (x 1,000 PSI)
	1 (in.)	2 BSPP									S
6-4XEMK46	3/8	1/4-19	9/16-18	7.5	4.4	26.9	33.2	19	25.2	19	4.0
6XEMK46	3/8	3/8-19	9/16-18	7.5	7.9	26.9	32.6	22	29.7	19	4.0
8-6XEMK46	1/2	3/8-19	3/4-16	9.9	7.9	31.8	32.6	22	32.5	19	4.0
8XEMK46	1/2	1/2-14	3/4-16	9.9	11.0	31.8	38.8	27	33.0	22	4.0
10-8XEMK46	5/8	1/2-14	7/8-14	12.3	9.9	36.8	38.8	27	31.6	22	4.0
12XEMK46	3/4	3/4-14	1 1/16-12	15.5	15.5	42.2	40.3	32	33.0	27	4.0
12-16XEMK46	3/4	1-11	1 1/16-12	15.5	21.4	42.2	48.8	41	37.7	33	3.0
16XEMK46	1	1-11	1 5/16-12	21.5	21.4	46.0	48.8	41	37.7	33	3.0

Dimensions and pressures for reference only, subject to change.

