

## LOHT3

Tube Stub Connector  
ORFS / Tube Weld

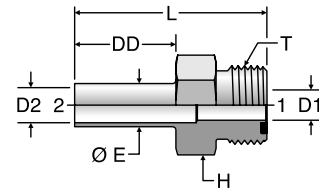

TUBE FITTING PART #	END SIZE	T TUBE END UN/UNF-2A	D1 DRILL (in.)	D2 DIA (in.)	DD (in.)	E DIA (in.)	H HEX (in.)	L (in.)	Dynamic Pressure (x 1,000 PSI)
	1 & 2 (in.)								-SS
4-4X035 LOHT3	1/4	9/16 - 18	0.177	0.18	0.88	0.25	5/8	1.58	5.9
6-6X035 LOHT3	3/8	11/16 - 16	0.256	0.31	0.88	0.38	3/4	1.67	3.8
8-8X065 LOHT3	1/2	13/16 - 16	0.374	0.37	1.00	0.50	7/8	1.89	5.5
12-12X065 LOHT3	3/4	1 3/16 - 12	0.610	0.62	1.16	0.75	1 1/4	2.35	3.5
12-16X065 LOHT3	1	1 3/16 - 12	0.610	0.87	1.13	1.00	1 1/4	2.32	2.6
16-16X065 LOHT3	1	1 7/16 - 12	0.807	0.87	1.13	1.00	1 1/2	2.40	2.6

All o-rings and seals are shown in [Section N](#) of this catalog.  
\*Contact [Tube Fittings Division](#) for pressure ratings.

Dimensions and pressures for reference only, subject to change.

