

# JTX

Union Tee  
37° Flare (all three ends)

SAE 070401

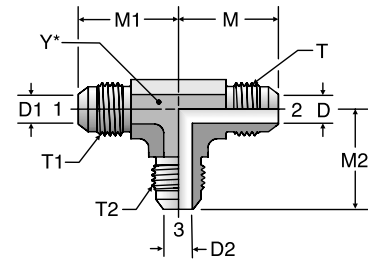

Y\* – Across wrench flats

TUBE FITTING PART #	HOSE FITTING PART #	END SIZE			T TUBE END UN/UNF-2A	T1 TUBE END UN/UNF-2A	T2 TUBE END UN/UNF-2A	D DRILL (in.)	D1 DRILL (in.)	D2 DRILL (in.)	M (in.)	M1 (in.)	M2 (in.)	Y (in.)	Dynamic Pressure (x 1,000 PSI)		
		1 (in.)	2 (in.)	3 (in.)											-S	-SS	-B
2 JTX	033T-2-2	1/8	1/8	1/8	5/16 - 24	5/16 - 24	5/16 - 24	0.062	0.062	0.062	0.77	0.77	0.77	5/16	7.5	7.7	3.3
3 JTX	033T-3-3	3/16	3/16	3/16	3/8 - 24	3/8 - 24	3/8 - 24	0.125	0.125	0.125	0.83	0.83	0.83	7/16	7.5	7.7	3.3
4 JTX	033T-4-4	1/4	1/4	1/4	7/16 - 20	7/16 - 20	7/16 - 20	0.172	0.172	0.172	0.89	0.89	0.89	7/16	7.5	7.7	3.3
4-4-3 JTX	033T-3-4-4	1/4	1/4	3/16	7/16 - 20	7/16 - 20	3/8 - 24	0.172	0.172	0.125	0.89	0.89	0.81	7/16	7.5	7.7	3.3
5 JTX	033T-5-5	5/16	5/16	5/16	1/2 - 20	1/2 - 20	1/2 - 20	0.234	0.234	0.234	0.95	0.95	0.95	9/16	6.0	6.0	3.3
6 JTX	033T-6-6	3/8	3/8	3/8	9/16 - 18	9/16 - 18	9/16 - 18	0.297	0.297	0.297	1.06	1.06	1.06	9/16	6.0	6.0	3.3
8 JTX	033T-8-8	1/2	1/2	1/2	3/4 - 16	3/4 - 16	3/4 - 16	0.391	0.391	0.391	1.25	1.25	1.25	3/4	6.0	6.0	3.3
10 JTX	033T-10-10	5/8	5/8	5/8	7/8 - 14	7/8 - 14	7/8 - 14	0.484	0.484	0.484	1.45	1.45	1.45	7/8	5.0	5.0	3.3
12 JTX	033T-12-12	3/4	3/4	3/4	1 1/16 - 12	1 1/16 - 12	1 1/16 - 12	0.610	0.610	0.610	1.66	1.66	1.66	1 1/16	5.0	5.0	2.9
12-12-8 JTX	033T-12-12-8	3/4	3/4	1/2	1 1/16 - 12	1 1/16 - 12	3/4 - 16	0.610	0.610	0.391	1.66	1.66	1.42	1 1/16	5.0	5.0	2.9
12-16-12 JTX	033T-16-12-12	3/4	1	3/4	1 1/16 - 12	1 5/16 - 12	1 1/16 - 12	0.610	0.844	0.610	1.77	1.81	1.77	1 5/16	4.0	3.5	2.3
14 JTX	033T-14-14	7/8	7/8	7/8	1 3/16 - 12	1 3/16 - 12	1 3/16 - 12	0.718	0.718	0.718	1.80	1.80	1.80	1 5/16	5.0	5.0	2.9
16 JTX	033T-16-16	1	1	1	1 5/16 - 12	1 5/16 - 12	1 5/16 - 12	0.844	0.844	0.844	1.81	1.81	1.81	1 5/16	4.0	3.5	2.3
20 JTX	033T-20-20	1 1/4	1 1/4	1 1/4	1 5/8 - 12	1 5/8 - 12	1 5/8 - 12	1.078	1.078	1.078	2.06	2.06	2.06	1 5/8	4.0	3.0	2.0
24 JTX	033T-24-24	1 1/2	1 1/2	1 1/2	1 7/8 - 12	1 7/8 - 12	1 7/8 - 12	1.312	1.312	1.312	2.33	2.33	2.33	1 7/8	3.0	2.0	1.5
24-16-16 JTX	033T-16-24	1 1/2	1	1	1 7/8 - 12	1 5/16 - 12	1 5/16 - 12	1.312	0.844	0.844	2.33	2.16	2.16	1 7/8	3.0	2.0	1.5
32 JTX	033T-32-32	2	2	2	2 1/2 - 12	2 1/2 - 12	2 1/2 - 12	1.781	1.781	1.781	3.06	3.06	3.06	2 1/2	2.0	1.5	1.0

Dimensions and pressures for reference only, subject to change.

