

FBU

Male Connector
Flareless / NPTF

SAE 080102

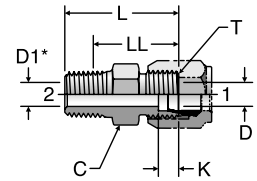

D1* – Drill may be present due to manufacturer's option per SAE J514

| TUBE FITTING PART # | HOSE FITTING PART# | END SIZE | | T TUBE END UN/UNF-2A | C HEX (in.) | D DRILL (in.) | D1 DRILL (in.) | K (in.) | L (in.) | LL AFTER ASSY (in.) | Dynamic Pressure (x 1,000 PSI) | |
|---------------------|--------------------|----------|----------------|----------------------|-------------|---------------|----------------|---------|---------|---------------------|--------------------------------|-----|
| | | 1 (in.) | 2 NPTF | | | | | | | | -S | -SS |
| 2 FBU | 0111-2-2 | 1/8 | 1/8 - 27 | 5/16 - 24 | 7/16 | 0.094 | 0.187 | 0.19 | 1.04 | 0.80 | 6.0 | 6.0 |
| 2-4 FBU | 0111-4-2 | 1/8 | 1/4 - 18 | 5/16 - 24 | 9/16 | 0.094 | 0.281 | 0.19 | 1.24 | 0.91 | 6.0 | 6.0 |
| 3 FBU | 0111-3-3 | 3/16 | 1/8 - 27 | 3/8 - 24 | 7/16 | 0.125 | 0.187 | 0.24 | 1.09 | 0.86 | 6.0 | 6.0 |
| 4 FBU | 0111-2-4 | 1/4 | 1/8 - 27 | 7/16 - 20 | 1/2 | 0.203 | 0.187 | 0.24 | 1.12 | 0.90 | 6.0 | 6.0 |
| 4-4 FBU | 0111-4-4 | 1/4 | 1/4 - 18 | 7/16 - 20 | 9/16 | 0.203 | 0.281 | 0.24 | 1.32 | 0.99 | 6.0 | 6.0 |
| 4-6 FBU | 0111-6-4 | 1/4 | 3/8 - 18 | 7/16 - 20 | 3/4 | 0.203 | 0.406 | 0.24 | 1.33 | 0.98 | 6.0 | 6.0 |
| 4-8 FBU | 0111-8-4 | 1/4 | 1/2 - 14 | 7/16 - 20 | 7/8 | 0.203 | 0.531 | 0.24 | 1.58 | 1.12 | 6.0 | 6.0 |
| 5 FBU | 0111-2-5 | 5/16 | 1/8 - 27 | 1/2 - 20 | 9/16 | 0.234 | 0.187 | 0.26 | 1.12 | 0.90 | 6.0 | 6.0 |
| 5-4 FBU | 0111-4-5 | 5/16 | 1/4 - 18 | 1/2 - 20 | 9/16 | 0.234 | 0.281 | 0.26 | 1.32 | 0.99 | 6.0 | 6.0 |
| 6 FBU | 0111-4-6 | 3/8 | 1/4 - 18 | 9/16 - 18 | 5/8 | 0.281 | 0.281 | 0.26 | 1.34 | 1.00 | 6.0 | 6.0 |
| 6-2 FBU | 0111-2-6 | 3/8 | 1/8 - 27 | 9/16 - 18 | 5/8 | 0.281 | 0.187 | 0.26 | 1.15 | 0.93 | 6.0 | 6.0 |
| 6-6 FBU | 0111-6-6 | 3/8 | 3/8 - 18 | 9/16 - 18 | 3/4 | 0.281 | 0.406 | 0.26 | 1.35 | 0.99 | 6.0 | 6.0 |
| 6-8 FBU | 0111-8-6 | 3/8 | 1/2 - 14 | 9/16 - 18 | 15/16 | 0.281 | 0.531 | 0.26 | 1.60 | 1.14 | 6.0 | 6.0 |
| 8 FBU | 0111-6-8 | 1/2 | 3/8 - 18 | 3/4 - 16 | 13/16 | 0.422 | 0.406 | 0.31 | 1.44 | 1.09 | 5.0 | 5.0 |
| 8-4 FBU | 0111-4-8 | 1/2 | 1/4 - 18 | 3/4 - 16 | 13/16 | 0.422 | 0.281 | 0.31 | 1.44 | 1.10 | 5.0 | 5.0 |
| 8-8 FBU | 0111-8-8 | 1/2 | 1/2 - 14 | 3/4 - 16 | 7/8 | 0.422 | 0.531 | 0.31 | 1.69 | 1.23 | 5.0 | 5.0 |
| 8-12 FBU | 0111-12-8 | 1/2 | 3/4 - 14 | 3/4 - 16 | 1 1/8 | 0.422 | 0.718 | 0.31 | 1.76 | 1.27 | 4.0 | 4.0 |
| 10 FBU | 0111-8-10 | 5/8 | 1/2 - 14 | 7/8 - 14 | 15/16 | 0.500 | 0.531 | 0.36 | 1.75 | 1.29 | 4.5 | 4.5 |
| 10-6 FBU | 0111-6-10 | 5/8 | 3/8 - 18 | 7/8 - 14 | 15/16 | 0.500 | 0.406 | 0.36 | 1.56 | 1.21 | 4.5 | 4.5 |
| 10-12 FBU | 0111-12-10 | 5/8 | 3/4 - 14 | 7/8 - 14 | 1 1/8 | 0.500 | 0.718 | 0.36 | 1.82 | 1.35 | 4.0 | 4.0 |
| 12 FBU | 0111-12-12 | 3/4 | 3/4 - 14 | 1 1/16 - 12 | 1 1/8 | 0.656 | 0.718 | 0.36 | 1.88 | 1.40 | 4.0 | 4.0 |
| 12-8 FBU | 0111-8-12 | 3/4 | 1/2 - 14 | 1 1/16 - 12 | 1 1/8 | 0.656 | 0.531 | 0.36 | 1.88 | 1.42 | 4.0 | 4.0 |
| 14 FBU | 0111-12-14 | 7/8 | 3/4 - 14 | 1 3/16 - 12 | 1 1/4 | 0.718 | 0.718 | 0.36 | 1.88 | 1.40 | 3.0 | 3.0 |
| 16 FBU | 0111-16-16 | 1 | 1 - 11 1/2 | 1 5/16 - 12 | 1 3/8 | 0.875 | 0.937 | 0.42 | 2.07 | 1.51 | 3.0 | 3.0 |
| 16-12 FBU | 0111-12-16 | 1 | 3/4 - 14 | 1 5/16 - 12 | 1 3/8 | 0.875 | 0.718 | 0.42 | 1.88 | 1.40 | 3.0 | 3.0 |
| 20 FBU | 0111-20-20 | 1 1/4 | 1 1/4 - 11 1/2 | 1 5/8 - 12 | 1 11/16 | 1.093 | 1.250 | 0.42 | 2.18 | 1.60 | 2.5 | 2.5 |
| 24 FBU | 0111-24-24 | 1 1/2 | 1 1/2 - 11 1/2 | 1 7/8 - 12 | 2 | 1.344 | 1.500 | 0.49 | 2.28 | 1.69 | 2.5 | 2.5 |
| 32 FBU | 0111-32-32 | 2 | 2 - 11 1/2 | 2 1/2 - 12 | 2 3/4 | 1.812 | 1.937 | 0.49 | 2.46 | 1.86 | 2.0 | 2.0 |

All "FBU" fittings include a 30° chamfer for sealing with NPSM swivel type fittings (steel only).

Dimensions and pressures for reference only, subject to change.

