

F8OMX

Male Connector – Metric
37° Flare / Metric-ORR

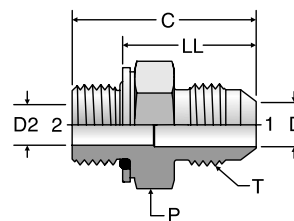

TUBE FITTING PART #	END SIZE			T TUBE END UN/UNF-2A	C (mm)	D (mm)	D2 (mm)	LL (mm)	P (mm)	Dynamic Pressure (x 1,000 PSI)		
	1		Male Metric Parallel Thread							S	SS	B
	(mm)	(in.)										
4M10F8OMX	6	1/4	M10x1	7/16 - 20	30.0	4.4	4.4	23.5	14	5.0	5.0	3.3
5M12F8OMX	8	5/16	M12x1.5	1/2 - 20	33.1	6.0	6.0	23.8	19	6.0	6.0	3.3
6M14F8OMX	10	3/8	M14x1.5	9/16 - 18	34.1	7.5	7.5	23.8	19	5.0	5.0	3.3
8M16F8OMX	12	1/2	M16x1.5	3/4 - 16	38.0	9.9	9.0	27.6	22	5.0	5.0	3.3
8M18F8OMX	12	1/2	M18x1.5	3/4 - 16	39.1	9.9	9.9	28.6	24	3.6	3.6	2.3
10M18F8OMX	14, 15, 16	5/8	M18x1.5	7/8 - 14	43.1	12.3	11.0	31.2	24	3.6	3.6	2.3
10M22F8OMX	14, 15, 16	5/8	M22x1.5	7/8 - 14	43.5	12.3	12.3	31.2	27	3.6	3.6	2.3
12M22F8OMX	18, 20	3/4	M22x1.5	1 1/16 - 12	48.0	15.5	14.0	33.8	27	3.6	3.6	2.3
12M24F8OMX	18, 20	3/4	M24x1.5	1 1/16 - 12	44.5	15.5	14.0	33.8	30	3.0	3.0	2.0
12M27F8OMX	18, 20	3/4	M27x2	1 1/16 - 12	50.9	15.5	15.5	35.0	32	3.0	3.0	2.0
16M27F8OMX	25	1	M27x2	1 5/16 - 12	50.5	21.5	18.0	36.5	36	3.0	3.0	2.0
16M33F8OMX	25	1	M33x2	1 5/16 - 12	52.7	21.5	21.5	37.6	41	3.0	3.0	2.0
20M42F8OMX	30, 32	1 1/4	M42x2	1 5/8 - 12	54.9	27.5	27.5	40.9	50	3.0	3.0	2.0
24M48F8OMX	38	1 1/2	M48x2	1 7/8 - 12	59.4	33.0	33.0	43.9	55	2.0	2.0	1.3

Note: If F8OMX is not available, use F82EDMX.

Dimensions and pressures for reference only, subject to change.

