

CLO

Male Pipe Elbow
ORFS / NPTF

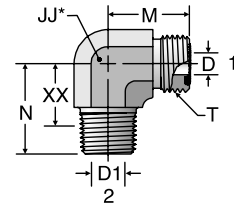

* JJ – Across Wrench Flats

TUBE FITTING PART #	END SIZE		T TUBE END UN/UNF-2A	D DRILL (in.)	D1 DRILL (in.)	JJ (in.)	M (in.)	N (in.)	XX AFTER ASSY (in.)	Dynamic Pressure (x 1,000 PSI)	
	1 (in.)	2 NPTF								-S	-SS
	4 CLO	1/4								1/8 - 27	9/16 - 18
4-4 CLO	1/4	1/4 - 18	9/16 - 18	0.177	0.281	9/16	0.85	1.12	0.78	6.0	6.0
4-6 CLO	1/4	3/8 - 18	9/16 - 18	0.177	0.406	3/4	0.97	1.22	0.87	6.0	6.0
4-8 CLO	1/4	1/2 - 14	9/16 - 18	0.177	0.531	7/8	1.07	1.47	1.01	6.0	6.0
6 CLO	3/8	1/4 - 18	11/16 - 16	0.256	0.281	3/4	0.98	1.09	0.75	6.0	6.0
6-6 CLO	3/8	3/8 - 18	11/16 - 16	0.256	0.406	3/4	0.98	1.22	0.87	6.0	6.0
6-8 CLO	3/8	1/2 - 14	11/16 - 16	0.256	0.531	7/8	1.15	1.47	1.01	6.0	6.0
8 CLO	1/2	3/8 - 18	13/16 - 16	0.374	0.406	3/4	1.10	1.22	0.87	6.0	6.0
8-4 CLO	1/2	1/4 - 18	13/16 - 16	0.374	0.281	3/4	1.10	1.22	0.87	6.0	6.0
8-8 CLO	1/2	1/2 - 14	13/16 - 16	0.374	0.531	7/8	1.10	1.47	1.01	6.0	6.0
8-12 CLO	1/2	3/4 - 14	13/16 - 16	0.374	0.719	1 1/16	1.32	1.59	1.11	4.0	4.0
10 CLO	5/8	1/2 - 14	1 - 14	0.492	0.531	1 1/16	1.31	1.47	1.01	6.0	6.0
10-6 CLO	5/8	3/8 - 18	1 - 14	0.492	0.406	1 1/16	1.31	1.28	0.93	6.0	6.0
10-12 CLO	5/8	3/4 - 14	1 - 14	0.492	0.719	1 3/16	1.41	1.59	1.11	4.0	4.0
12 CLO	3/4	3/4 - 14	1 3/16 - 12	0.610	0.719	1 3/16	1.47	1.59	1.11	4.0	4.0
12-8 CLO	3/4	1/2 - 14	1 3/16 - 12	0.610	0.531	1 3/16	1.47	1.59	1.13	6.0	6.0
12-16 CLO	3/4	1 - 11 1/2	1 3/16 - 12	0.610	0.938	1 5/16	1.62	1.97	1.40	3.0	3.0
16 CLO	1	1 - 11 1/2	1 7/16 - 12	0.807	0.938	1 7/16	1.64	1.97	1.40	3.0	3.0
16-12 CLO	1	3/4 - 14	1 7/16 - 12	0.807	0.719	1 7/16	1.64	1.78	1.30	4.0	4.0
20 CLO	1 1/4	1 1/4 - 11 1/2	1 11/16 - 12	1.024	1.250	1 5/8	1.76	2.38	1.79	2.5	2.5
24 CLO	1 1/2	1 1/2 - 11 1/2	2 - 12	1.260	1.500	1 7/8	1.92	2.64	2.05	2.5	2.5
24-20 CLO	1 1/2	1 1/4 - 11 1/2	2 - 12	1.260	1.250	1 7/8	1.92	2.61	2.02	2.5	2.5

All o-rings and seals are shown in Section N of this catalog.

* Size 14 is not included in SAE J1453.

Dimensions and pressures for reference only, subject to change.

