

# 217T

Male Pipe Branch Tee  
NPTF / NPSM Swivel /  
NPSM Swivel

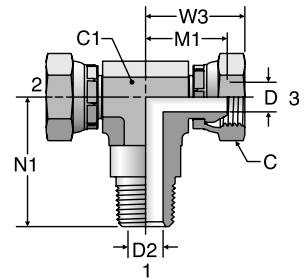

TUBE FITTING PART #	END SIZE			C HEX (in.)	C1 HEX forg (in.)	D DRILL (in.)	D2 DRILL (in.)	M1 (in.)	N1 (in.)	W3 (in.)	Dynamic Pressure (x 1,000 PSI)		
	1	2	3								-S	-SS	-B
	NPTF	NPSM	NPSM										
217T-2-2	1/8 - 27	1/8 - 27	1/8 - 27	9/16	9/16	0.156	0.188	0.77	0.97	0.92	6.0	6.0	3.3
217T-4-4	1/4 - 18	1/4 - 18	1/4 - 18	11/16	9/16	0.219	0.281	0.85	1.19	1.03	6.0	6.0	3.3
217T-6-6	3/8 - 18	3/8 - 18	3/8 - 18	7/8	3/4	0.344	0.406	0.95	1.50	1.15	6.0	6.0	3.3
217T-8-6	1/2 - 14	3/8 - 18	1/2 - 14	7/8	3/4	0.344	0.531	1.01	1.69	1.21	6.0	6.0	3.3
217T-8-8	1/2 - 14	1/2 - 14	1/2 - 14	1	3/4	0.469	0.531	1.06	1.81	1.35	5.0	5.0	3.3
217T-12-12	3/4 - 14	3/4 - 14	3/4 - 14	1 1/4	1 1/16	0.641	0.719	1.25	2.00	1.60	3.0	3.0	1.9
217T-16-16	1 - 11 1/2	1 - 11 1/2	1 - 11 1/2	1 1/2	1 1/16	0.844	0.938	1.49	2.37	1.86	2.5	2.5	1.6

Dimensions and pressures for reference only, subject to change.

