

SOLENOID TUBE GASKET INSTRUCTIONS

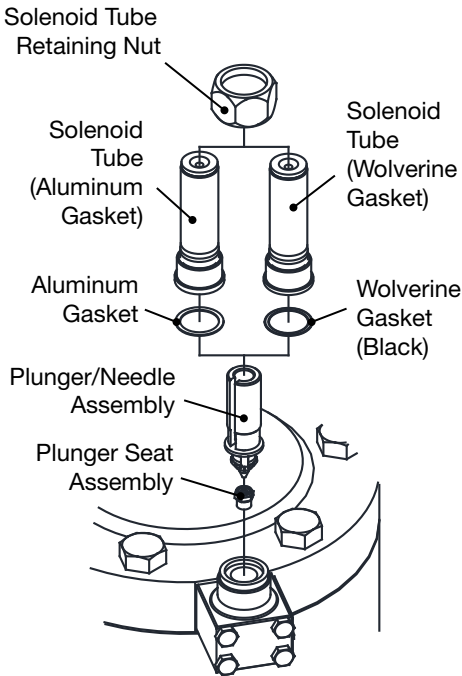

Old Aluminum Gasket/Tube
(Prior 6/22/12)

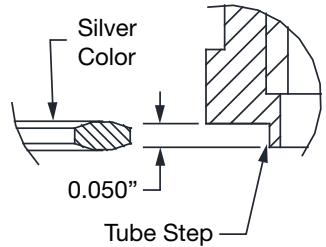

New Wolverine Gasket/Tube
(After 6/22/12)

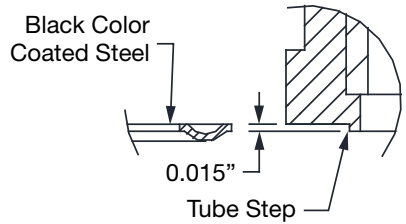

Note: There are two different solenoid tube gaskets supplied in this kit. Appropriately match the existing gasket with the one in the kit. The gasket thickness will match the depth of the tube step as shown in the cross-sectional diagram above.

INSTALLATION AND REPLACEMENT

CAUTION: Turn off electrical power supply

1. Remove knob and coil from the solenoid tube assembly
2. Unbolt the solenoid tube retaining nut, remove solenoid tube and plunger assembly
3. Replace the gasket (used same gasket in kit as what is being replaced)
4. Re-assemble in reverse order
5. Solenoid Tube Torque Specification:
 - Wolverine Gasket - 8.3 mkg (60 ft-lbs)
 - Aluminum Gasket - 15 mkg (110 ft-lbs)

Refrigerating Specialties Division

Parker Hannifin Corporation
Refrigerating Specialties Division
2445 South 25th Avenue
Broadview, IL 60155-3891 USA
Phone: (708) 681-6300
Fax: (708) 681-6306

ISO 9001 CERTIFIED

