

# Turbine Series - 500MA/500MAM

# FUEL

## Specifications:

**Height:** MA - 10.82" (27.48 cm)  
MAM - 10.77" (27.36 cm)

**Width:** 4.15" (10.5 cm)  
with Bracket 6.5" (16.51 cm)

**Depth:** 4.15" (10.5 cm)  
with Bracket 5.17" (13.13 cm)

**Weight:** MA - 4.0 lbs (1.8 kg)  
MAM - 5.0 lbs (2.2 kg)

**Ports:** 3/4"-16 UNF (SAE J1926)

**Service Clearance (Top):** 4.0" (10.16 cm)

**Vacuum Installation Recommended**  
**Maximum Pressure:** 15 psi (1.03 bar)  
**Max Flow Rate:** 60 gph (227 lph)

## Create a Part Number

Housing Type	Assembly Options	Filtration Rating
Turbine Model - Marine <b>Standard 3/4"-16 Ports</b> Clear Bowl/Heat Shield	Metal Bowl Option	2 micron 10 micron 30 micron
500MA	M	2 10 30

**RACOR®**

## Dimensions:

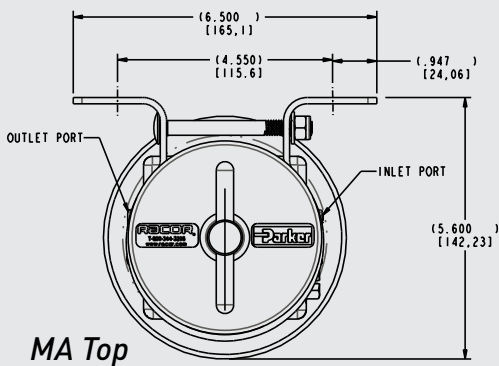

MA Top

ASSEMBLY	DESCRIPTION
500MA2	Marine - 500 Turbine Assy., 2 micron Filter
500MA10	Marine - 500 Turbine Assy., 10 micron Filter
500MA30	Marine - 500 Turbine Assy., 30 micron Filter
500MAM2	Marine - Metal Bowl - 500 Turbine Assy., 2 micron Filter
500MAM10	Marine - Metal Bowl - 500 Turbine Assy., 10 micron Filter
500MAM30	Marine - Metal Bowl - 500 Turbine Assy., 30 micron Filter

SINGLE ASSEMBLY

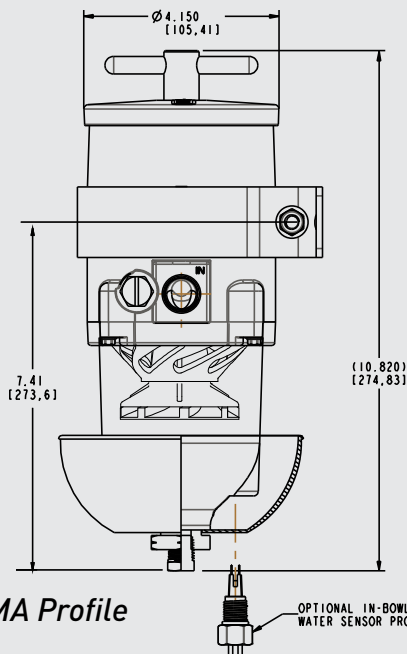

MA Profile

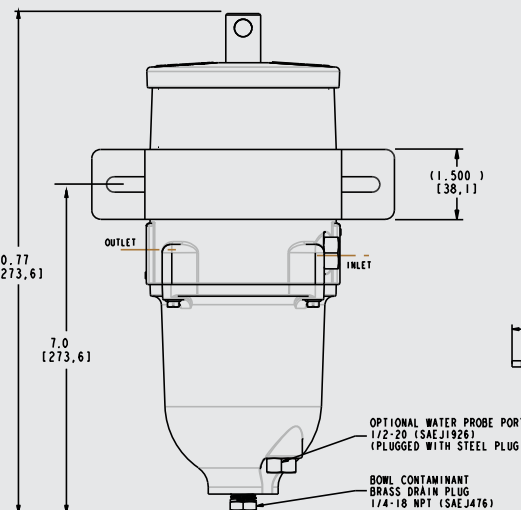

MAM Front

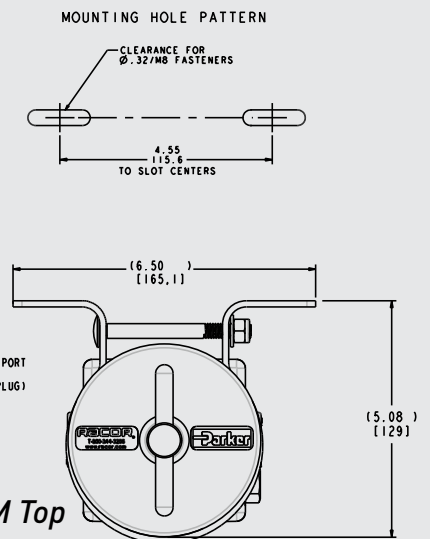

MAM Top



**WARNING:** The products described in this literature can expose you to chemicals including Diisononyl phthalate, Carbon black extract, which are known to the State of California to cause cancer. For more information go to [www.P65Warnings.ca.gov](http://www.P65Warnings.ca.gov).

# PARTS

# Turbine - 500MA/500MAM

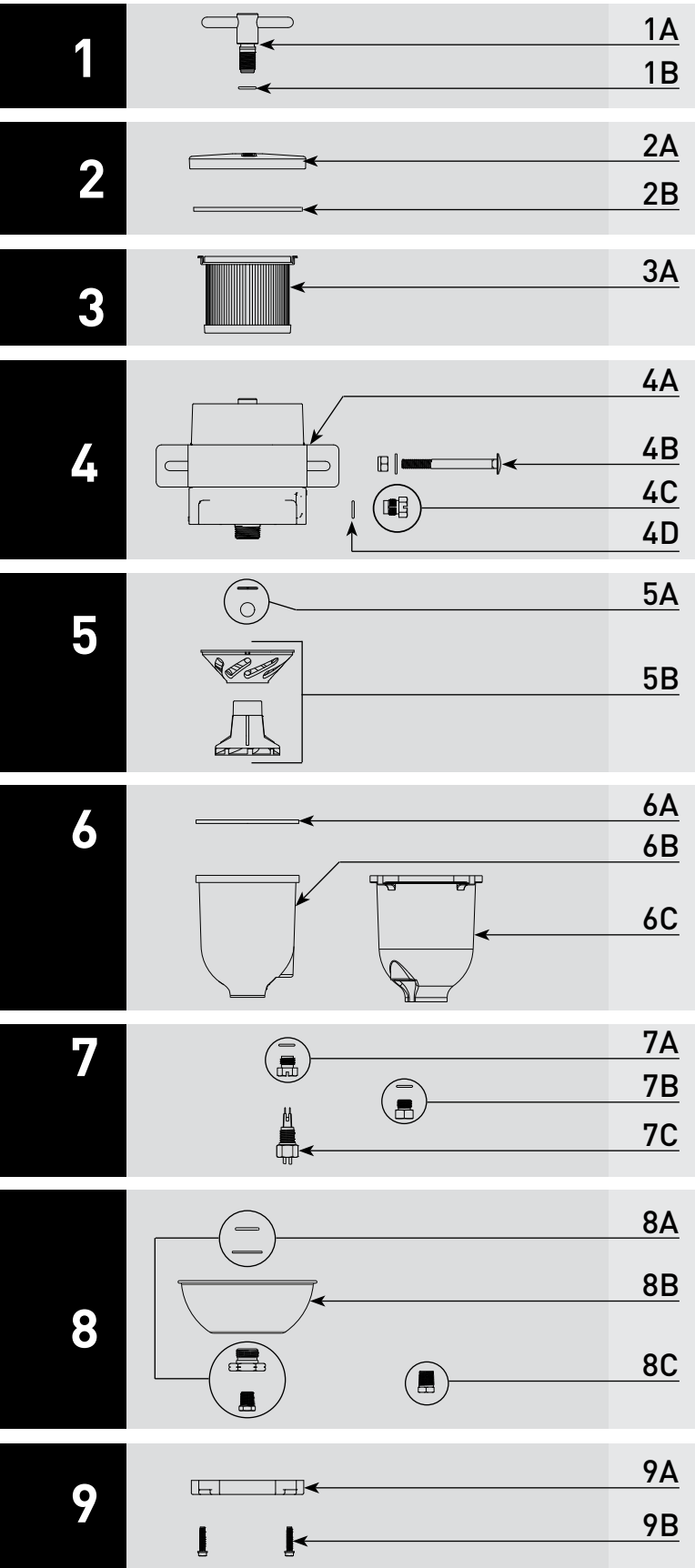

Part #		Description
1A	RK23183 RK19671	T-handle Kit - <b>Includes 1B</b> <i>Optional</i> - T-handle Vacuum Gauge Kit - <b>For 500MA/MAM Assemblies Manufactured After 2002</b>
	1B	T-handle O-ring
2A	RK15078-02	500MA/MAM Lid Kit - <b>Includes 1B and 2B</b>
2B		Lid Gasket - <b>Included in 10A</b>
3A	2010SM-OR	Replacement Element 2 micron - <b>Includes 1B and 2B</b>
	2010TM-OR	Replacement Element 10 micron - <b>Includes 1B and 2B</b>
	2010PM-OR	Replacement Element 30 micron - <b>Includes 1B and 2B</b>
4A	RK15441-01	Clamp Bracket Kit - <b>Includes (1) Bolt, (1) Washer, and (1) Nut</b>
4B	RK 11838	Carriage Bolt Kit - <b>Includes (2) Bolt, (2) Washer, and (2) Nut</b>
4C	RK 11-1679	Feed-thru Plug Kit - <b>Includes 4D</b>
4D		Plug O-ring - <b>Included in 10A</b>
5A	RK 15010B	Checkball and Gasket Kit
5B	RK 15013D	Centrifuge and Baffle Kit - <b>Includes 5A and 6A</b>
6A		Bowl Gasket - <b>Included in 10A</b>
6B	RK 15279-01	Bowl Kit (Clear) - <b>Includes 6A, 7A and 8A Seal/Gasket</b>
6C	RK 15301-02	Bowl Kit (Metal) - <b>Includes 6A, 7B, 8C and 9B</b>
7A	RK 20126	Bowl Plug Kit (MA) - Nylon - 1/2"-20 UNF
7B	RK 20022	Bowl Plug Kit (MAM) - Metal - 1/2"-20 UNF
7C	RK 21069	WIF Probe Kit - 1/2"-20 UNF - 2-wire (MA) - <i>Requires 10C</i>
	RK23191	WIF Probe Kit (Stainless Steel) - 1/2"-20 UNF - 2-wire (MAM) - <i>Requires 10C</i>
8A	RK 11-1910	Drain Plug Kit (MA)
8B	RK 15104	Heat Deflector (MA) - <b>Includes 8A</b>
8C		Drain Plug (MAM) - <i>Contact Technical Support</i>
9A	RK 15035-01	Bowl Ring - (For MA Only - White) <b>Includes 6A</b>
9B	RK 15081	Bowl Fasteners ( <b>set of 4</b> )
<b>Accessories and Parts Available (Not Shown)</b>		
10A	RK 15211	<b>Complete Seal Service Kit - 500 Series Filters</b>
10B	RK 14329	Water Detection Module - 12 vdc
	RK 14321	Water Detection Module - 24 vdc
10C	RK 19492	Shut-off Valve Drain Kit - UL Listed

Model  
MA



Model  
MAM

