

## Hand Operated Sliding Seal Valves

Sliding seal valves provide 3 or 4-Way directional control in a compact body size. Comfortable hand lever is easy to operate and maintains set position. Disc type valve has minimum number of moving parts. Valves should be used with filtered and lubricated air.

**CAUTION:**  
 Install guards on all hand operated valves.  
 Accidental operation can cause personal injury.

### Material specifications

Internal components	Brass, stainless steel
Body	Die cast zinc
Seals	Buna N

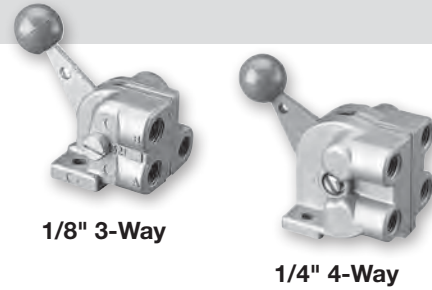

1/8" 3-Way

1/4" 4-Way

### Operating information

Operating pressure: Max. 200 PSIG air only  
 Min. 26" Hg vacuum  
 Temperature range: -40°F to 212°F (-40°C to 100°C)  
 (If it is possible that the ambient temperature may fall below freezing, the medium must be moisture free to prevent internal damage or unpredictable behavior.)

### Hand Operated Sliding Seal Valve

Symbol	Port size	Function	Cv (Avg)	Service kit*	Part number
	1/8"	3-way, 2-position, detented	0.54	<b>032130899</b>	<b>032130599</b>
	1/8"	4-way, 2-position, detented	0.54	<b>032130899</b>	<b>032140299</b>
	1/4"	3-way, 2-position, detented	1.25	<b>008230299</b>	<b>008230109</b>
	1/4"	4-way, 3-position, detented, center blocked	1.25	<b>008230299</b>	<b>008240109</b>

Note: 3-Way exhaust passage is through an untapped hole in bottom side of valve.

#### 1/8" 3-Way 032130599

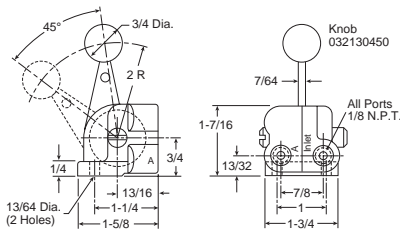

#### Service Kit 032130899\*

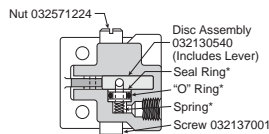

#### 1/8" 4-Way 032140299

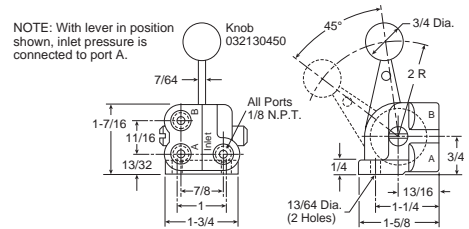

#### Service Kit 032130899\*

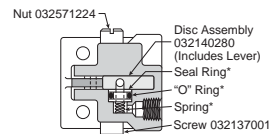

#### 1/4" 3-Way 008230109

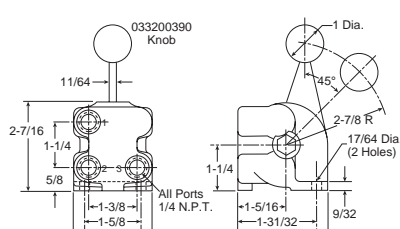

#### Service Kit 032130899\*

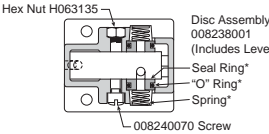

#### 1/4" 4-Way 008240109

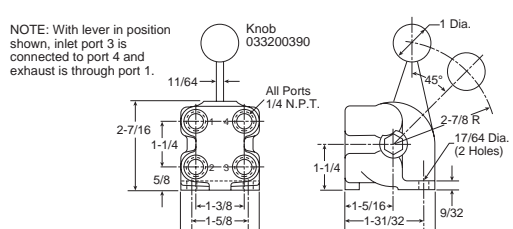

#### Service Kit 032130899\*

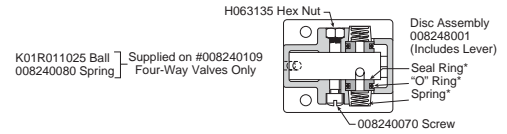

Most popular.

\* Service kits contain asterisk items



Directair 2,  
Directair 4

Viking Xtreme  
Lever Series

42 Lever/  
Pedal Series

M0  
Series

LV-EZ Series  
Lockout Valves

Brass Poppet/  
Sliding Seal

**D**

Manual / Mechanical  
Valve Products