

# Chelsea® 870 Series

## Ten Bolt PowerShift PTO



### Overview:

Power density is what you will find in the Chelsea 870 Series PTO. The 870 Series has a 10-Bolt mounting pattern that will fit on today's popular automatic transmissions. Its compact housing eliminates clearance issues. Two assembly arrangements to maximize your installation possibilities. High capacity bearings and superior gear designs provide you with torque ratings up to 670 lbs-ft for ultimate performance. There is no need to de-rate the PTO for continuous duty applications. A single hose is required for a simplified installation. Our popular Electronic Overspeed Control (EOC) is also available to protect your driven equipment. Multiple gear ratios provide a wide variety of speeds to meet a variety of application requirements. Direct mount pump flange options are available with our Wet Spline design to increase PTO and pump shaft life. Versatility, power, ease of maintenance and installation make the 870 Series the only choice for your vocational truck requirements.

- Fire & Rescue
- Refuse
- Vacuum
- Oil & Gas
- Snow & Ice



### Contact Information:

Parker Hannifin Corporation  
**Chelsea Products Europe**  
Building 93, Vantage Point  
Kingswinford, DY6 7FR  
GROSSBRITANNIEN

**Phone:** +44 (0) 1384 282777

**Fax:** +44 (0) 1384 401851

[chelseacustserv@parker.com](mailto:chelseacustserv@parker.com)

[www.parker.com/chelsea](http://www.parker.com/chelsea)

### Product Features and Benefits:

- **Power** – Torque capacity up to 670 lbs-ft / 908 Nm.
- **Compact** – Housing height reduces clearance issues.
- **Simplified** – Integral shift valve simplifies installation.
- **Smart Start** – Option available to reduce shock load at start-up for certain applications.
- **Insurance** – Electronic Overspeed Control (EOC) protects driven equipment.
- **Speeds** – Nine speed ratios.
- **Outputs** – Thirteen output options.
- **Protection** – Wet Spline pump flange extends PTO and pump shaft life.



ENGINEERING YOUR SUCCESS.

# 870 SERIES POWER TAKE-OFF SPECIFICATIONS AND TECHNICAL DATA

**870 X A FJ P - B 5 XV**

**Basic Model**  
870

**Mounting Option**  
X = Standard Mount w/ Metric Studs

**Gear Ratio (Internal)**  
 A = 24/40  
 B = 25/39  
 C = 26/38  
 D = 27/37  
 E = 29/35  
 F = 31/33  
 G = 33/31  
 H = 34/30  
 J = 35/29

**Input Option**  
FJ  
 NOTE: For more details, see Application Catalog (Transmission model number required)

**Lube Option**  
**Pressure**  
 P = Pressure Lube Only  
<sup>5</sup>R = Valve Body Rotated 120°  
<sup>5</sup>S = Valve Body Rotated 240°  
**Wet Spline**  
<sup>5</sup>W = Wet Spline  
<sup>5</sup>V = Valve Body Rotated 120° w/ Wet Spline  
<sup>5</sup>Y = Valve Body Rotated 240° w/ Wet Spline

**Output Option**  
**Driveline Output**  
 XV = 1410 Series Companion Flange  
 AB = DIN 120 Flange  
 AC = DIN 100 Flange  
 BB = Shaft Brake - DIN 120 Flange  
 BC = Shaft Brake - DIN 100 Flange  
 BV = Shaft Brake - 1410 Series Companion Flange  
 SB = Smart Start - DIN 120 Flange  
 SC = Smart Start - DIN 100 Flange  
 SV = Smart Start - 1410 Series Companion Flange  
**Pump Mount**  
<sup>47</sup>RF = Rotatable SAE B 2 or 4-Bolt Flange, SAE BB Shaft (1" - 15T)  
<sup>47</sup>RZ = Rotatable SAE B 2 or 4-Bolt Flange SAE C Shaft (1-1/4" - 14T)  
<sup>47</sup>RS = Rotatable SAE C 2 or 4-Bolt Flange, SAE C (1-1/4" - 14T)  
<sup>47</sup>RY = Rotatable ISO 7653 Pump Mount DIN 5462 Shaft

**Assembly Arrangement**  
 3 = Right side - bulge down  
   Left side - bulge up  
 5 = Left side - bulge down  
   Right side - bulge up

**Shift Option**  
 B = 12V Elec/Hyd  
 D = 24V Elec/Hyd  
 E = 12V Elec/Hyd w/o Installation Kit  
 N = 24V Elec/Hyd w/o Installation Kit  
 K = 12V Elec/Hyd w/ EOC  
 L = 24V Elec/Hyd w/ EOC  
 G = 12V Elec/Hyd Valve w/o EOC - Remote  
 H = 24V Elec/Hyd Valve w/o EOC - Remote

<sup>5</sup> Automatically pressure lubed  
<sup>47</sup> Available with Wet Spline

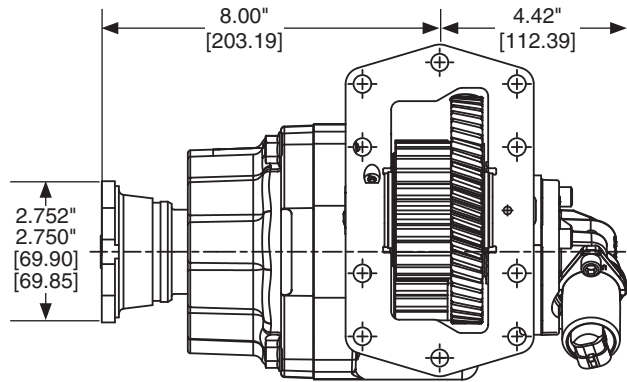
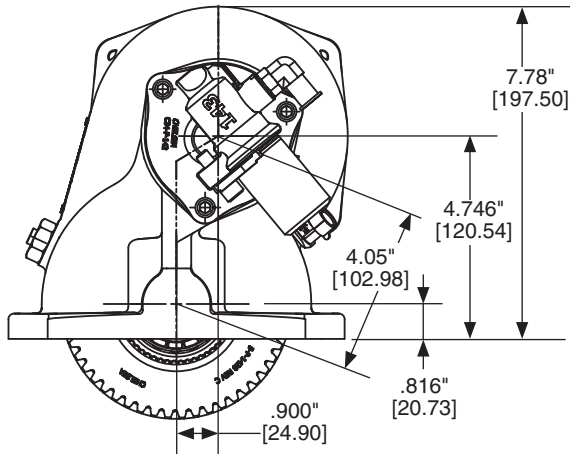

## Specifications Chart

Approximate Weight: 56 lbs. [25 kg]

	870*A	870*B	870*C	870*D	870*E	870*F	870*G	870*H	870*J
Continuous Torque Rating (lbs-ft) [Nm]	670 [908]	630 [854]	590 [800]	550 [746]	485 [658]	430 [583]	380 [515]	355 [481]	335 [454]
HP Rating for Continuous Duty									
At 500 RPM of Output Shaft (HP) [Kw]	64 [48]	60 [45]	56 [42]	52 [39]	46 [35]	41 [31]	36 [27]	34 [25]	32 [24]
At 1000 RPM of Output Shaft (HP) [Kw]	128 [95]	120 [90]	112 [84]	105 [78]	92 [69]	82 [61]	72 [54]	68 [51]	64 [48]

© 2018 Parker Hannifin Corporation

Supersedes HY25-0152-B1/UK September 2017

HY25-0152-B1/UK July 2018