

U.S. EXPORT CONTROLLED

Dissemination is restricted by the Export Administration Act of 1979 (50 U.S.C. App. 2401, et seq) and the Export Administration Regulations.

30-233C BRAKE ASSEMBLY – 075-01500 TORQUE PLATE – INSPECT/REPLACE

1. PLANNING INFORMATION

A. APPLICABILITY

This service bulletin is applicable to the following Parker Hannifin brake assemblies installed on the listed KAI aircraft and brake assembly units in stores.

<u>Parker Hannifin Part No.</u>	<u>Korean Aerospace Industries Model</u>	<u>Serial Number</u>
30-233C	KC-100	All

B. REASON

To improve functional interface with aircraft axle mount. Parker Hannifin has received reports indicating that the offset provided by the current axle flange location with the torque plate, P/N 075-01500, may cause lining to disc interference during taxi operations.

C. DESCRIPTION

This document provides the necessary instructions to replace the torque plate, P/N 075-01500 with P/N 075-01502.

- (1) Torque plate comparison. Refer to Figure 1.

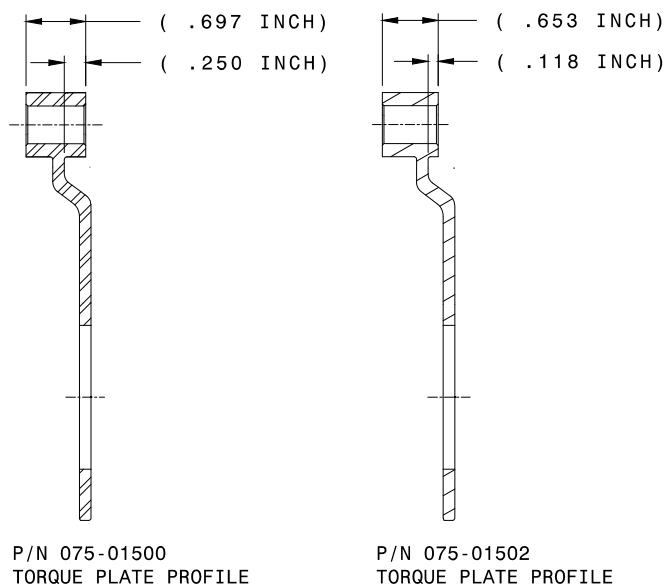

Figure 1 Torque plate comparison

30-233C BRAKE ASSEMBLY – 075-01500 TORQUE PLATE – INSPECT/REPLACE

(2) Torque plate interface. Refer to Figure 2.

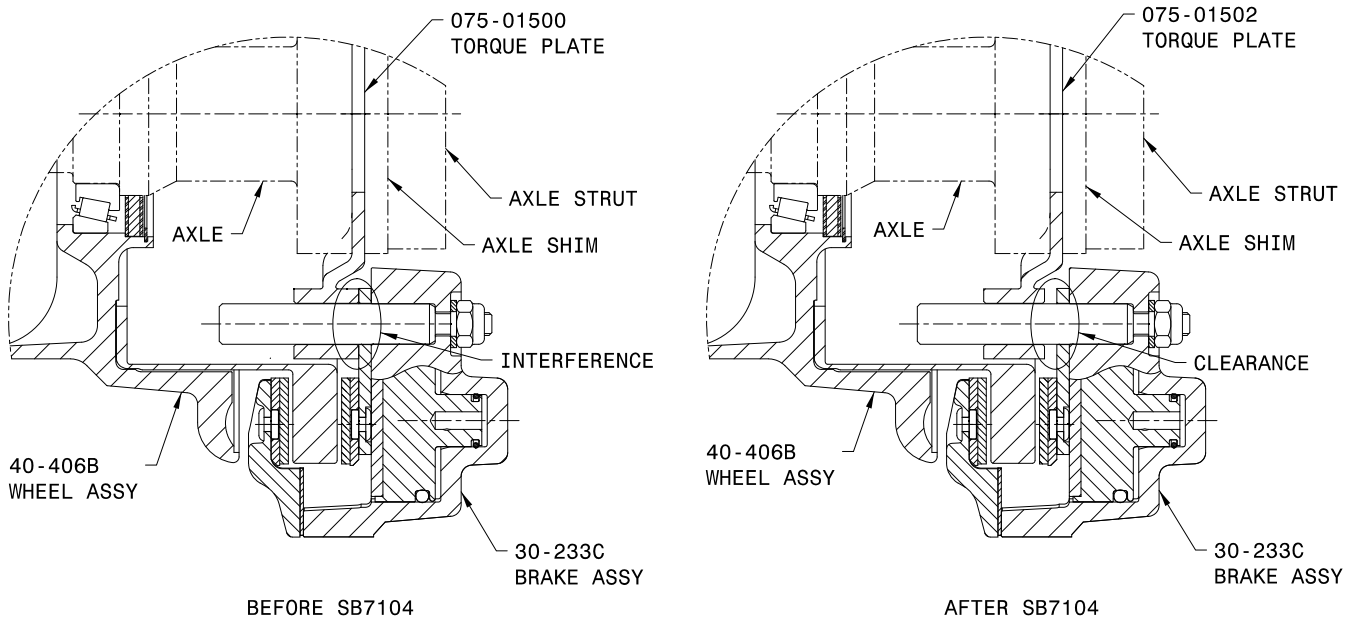

Figure 2 Torque plate interface

D. COMPLIANCE

Mandatory.

Effective before the next scheduled flight of the aircraft.

E. APPROVAL

This service bulletin is approved for support of an FAA TSO-C26 product.

F. MANPOWER

Estimate. 60 to 90 minutes per aircraft.

G. MATERIAL-COST AND AVAILABILITY

Refer to paragraph 3. Material Information.

30-233C BRAKE ASSEMBLY – 075-01500 TORQUE PLATE – INSPECT/REPLACE

H. TOOLING

No additional special tooling is required.

I. WEIGHT AND BALANCE

Not affected.

J. OTHER PUBLICATIONS AFFECTED

None.

K. PREVIOUS MODIFICATIONS

None.

2. ACCOMPLISHMENT INSTRUCTIONS

Instructions are per brake assembly.

SAFETY WARNING:  MAKE SURE THE AIRCRAFT IS SECURE AND STABLE BEFORE BEGINNING ANY WORK. WORKING AROUND AN AIRCRAFT THAT IS NOT SECURE AND STABLE CAN CAUSE INJURY OR DEATH.

A. REMOVE THE BRAKE ASSEMBLY

Refer to Figure 3.

NOTES:

- The brake does not have to be disconnected from the aircraft hydraulic line.
- To gain access to the torque plate, the brake assembly and wheel assembly must first be removed.

(1) Refer to Figure 3 and remove the 2X back plate assemblies (074-03001) by loosening the 4X bolts (103-11800) and washers (095-10400). Remove the shim (068-01100).

CAUTION: DO NOT LET THE BRAKE ASSEMBLY HANG FREELY WHILE ATTACHED TO THE AIRCRAFT HYDRAULIC LINE. DO NOT PINCH OR BIND THE HYDRAULIC LINE.

(2) Slide the brake caliper free from the torque plate. Temporarily support and secure the brake so that it will not impede removal of the torque plate or cause binding of the aircraft hydraulic line.

30-233C BRAKE ASSEMBLY – 075-01500 TORQUE PLATE – INSPECT/REPLACE

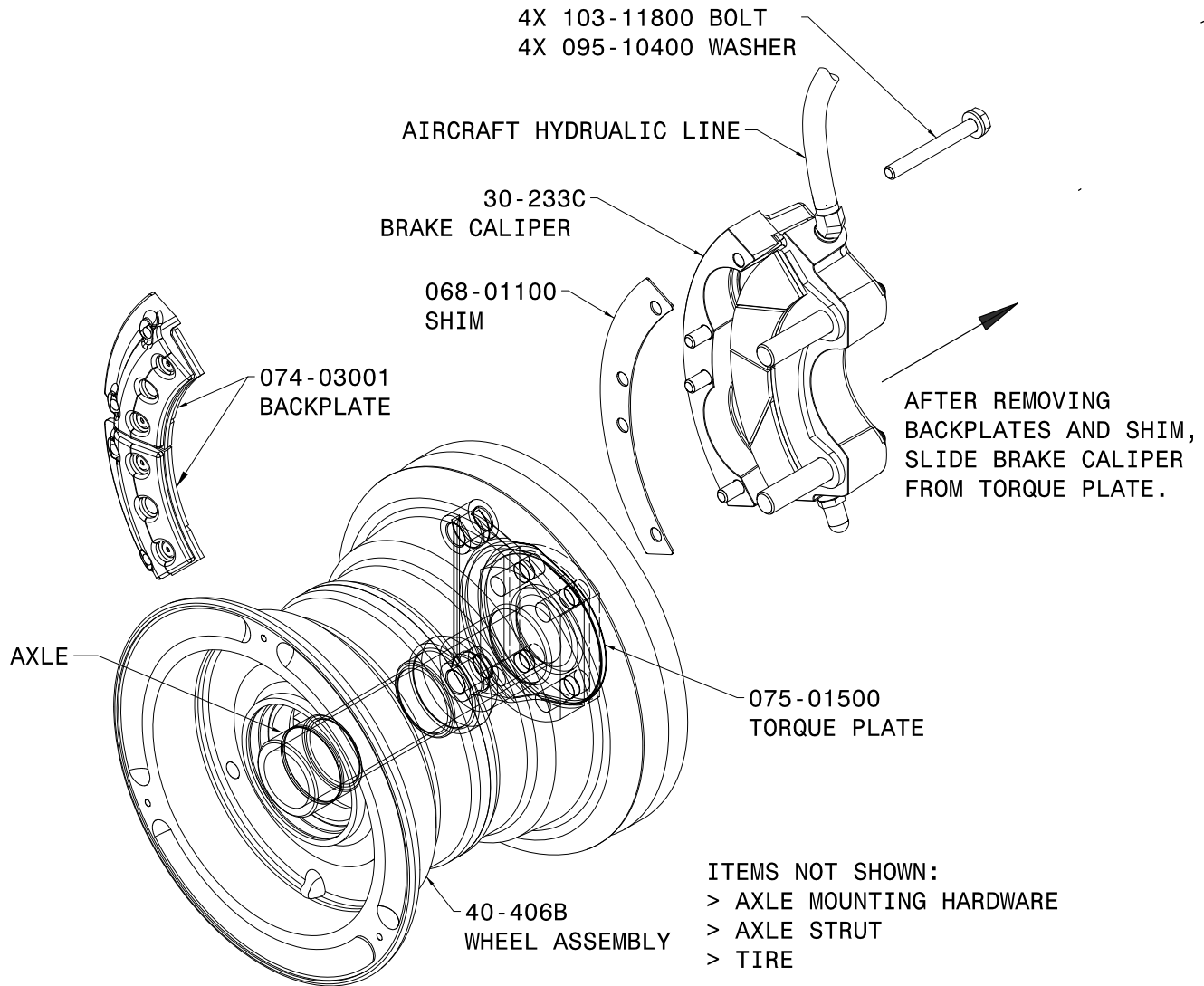

Figure 3 Remove the brake assembly

30-233C BRAKE ASSEMBLY – 075-01500 TORQUE PLATE – INSPECT/REPLACE

B. REMOVE THE WHEEL ASSEMBLY

Refer to Figure 4.

- (1) Remove the axle mounting hardware and slide the wheel/tire assembly from the axle.

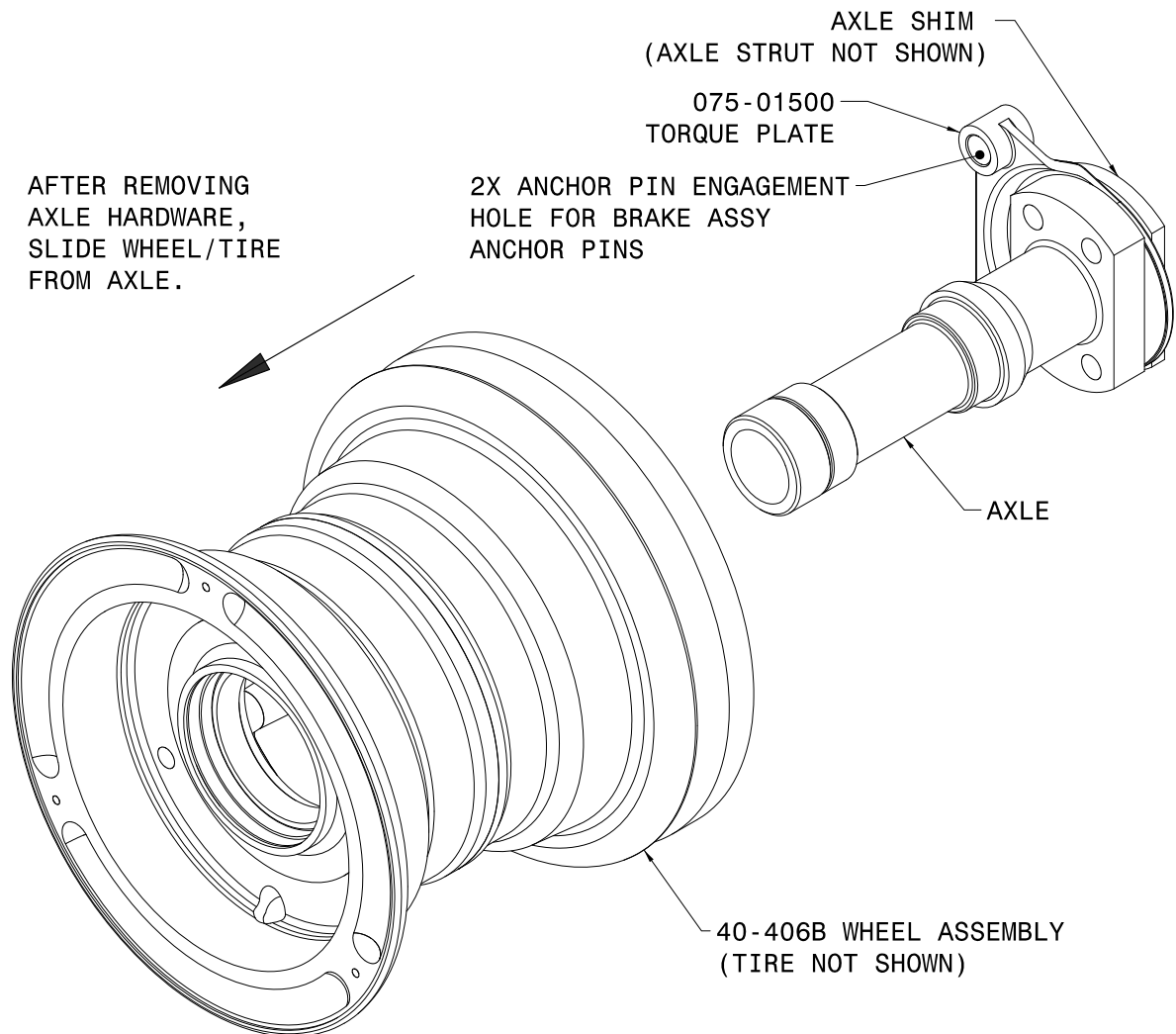

Figure 4 Remove the wheel/tire assembly



SERVICE BULLETIN

30-233C BRAKE ASSEMBLY – 075-01500 TORQUE PLATE – INSPECT/REPLACE

C. REMOVE THE OLD TORQUE PLATE P/N 075-01500

- (1) Remove the axle strut mounting hardware and remove the axle strut and axle shim.
- (2) Remove the 075-01500 torque plate.

D. INSTALL THE NEW TORQUE PLATE P/N 075-01502

- (1) Align the new torque plate, P/N 075-01502, against the axle flange.
- (2) Align the axle shim and axle strut against the torque plate. Install the axle strut mounting hardware and tighten in accordance with the airframe manufacturer's instructions.

E. MOUNT THE WHEEL/TIRE ASSEMBLY AND BRAKE ASSEMBLY

- (1) Slide the wheel/tire assembly onto the axle making sure the inboard bearing is seated. Install the axle hardware and tighten in accordance with the airframe manufacturer's instructions.
- (2) Mount the brake assembly onto the torque plate. The brake assembly anchor pins slide into the torque plate anchor pin engagement holes.
- (3) Install the 4X bolts (103-11800) and washers (095-10400) into the brake caliper.
- (4) Install the shim (068-01100).
- (5) Slide the 2X back plate assemblies (074-03001) between the brake disc and the wheel/tire and thread the bolts (103-11800) into the back plates. Tighten the bolts to 90 lb-in (10.2 N-m).
- (6) Make sure the wheel rotates freely and the brake assembly anchor pins slide in the torque plate without binding.

F. LOGBOOK ENTRY

- (1) Make the appropriate airframe logbook entry of compliance.

3. MATERIAL INFORMATION

A. MATERIAL-REQUIREMENTS

Contact Parker Hannifin for replacement hardware availability.

Parker Hannifin Corporation
Aircraft Wheel & Brake Division
Technical Service Hotline: 1-800-BRAKING
Customer Support Fax: 440-937-5409
E-mail: clevelandwbhelp@parker.com

30-233C BRAKE ASSEMBLY – 075-01500 TORQUE PLATE – INSPECT/REPLACE

B. LIST OF COMPONENTS

NOTE: Quantities are per brake assembly.

New part number	Name	Qty	Old part number	Qty	Operation
075-01502	Torque plate	1	075-01500	1	Replace

C. INTERCHANGEABILITY

None.

D. PARTS DISPOSITION

Discard the following removed components from the brake assembly:

P/N 075-01500 Torque plate