

New Output Option for 245 Series "XE" 5/8"- 9 Tooth Option

With the release of the 245 Series power take-off back in November 2002 for the Ford TorqShift™ transmission, Chelsea is please to add the "XE" output option to the list of options available for the 245 Series. This new option now gives you and your customers 4 output options. The "XD" 1.25" keyed shaft, "XP" S.A.E. "A" 2 bolt with 7/8"-13 tooth splined shaft, "AD" S.A.E. 2 bolt with 3/4"-11 tooth splined shaft and now the "XE" S.A.E. "A" 2 bolt with 5/8"-9 tooth splined shaft.

Please add this sheet to your 245 Series parts list (HY25-2245-M1/US) for reference.

XE Output
5/8"- 9 Tooth Shaft
S.A.E. Class "A" 2 Bolt Flange

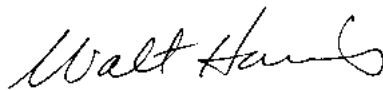
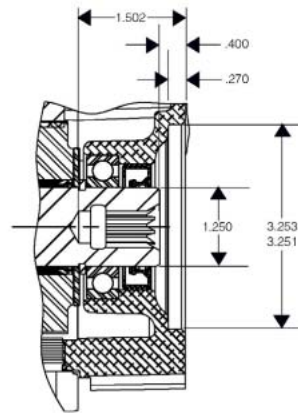
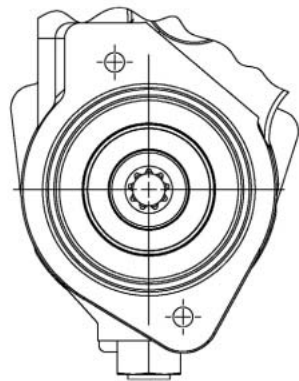

Walt Harris
Product Sales Manager
Chelsea Products Division